



iBoard® Series

INSTALLATION INSTRUCTIONS

PART#: IB-R115

BEFORE INSTALLATION

REMOVE CONTENTS FROM BOX. VERIFY ALL PARTS ARE PRESENT. READ INSTRUCTIONS CAREFULLY BEFORE STARTING INSTALLATION. ASSISTANCE IS RECOMMENDED. THANK YOU FOR CHOOSING OUR PRODUCT!

These instructions are provided for reference only. We strongly recommend installation by a professional installer for the best results. We are not responsible for any damage caused during installation.

***ROCKER PANEL MOUNT**

***NO DRILLING REQUIRED**

Torque Value

Fastener Size	Tightening Torque (ft-lbs)	Required
6mm	6-7	√
8mm	16-18	√
10mm	31-32	X
12mm	56-58	X
14mm	92-94	X



Scan for
Installation Video

Mounting Bracket List			
Item	QTY	Bracket Label	Description
1#	2	DFM	Mounting Bracket for Driver / Passenger Front
2#	2	DCM	Mounting Bracket for Driver / Passenger Center
3#	2	DRM	Mounting Bracket for Driver / Passenger Rear
4#	2	DFB	Bar Bracket for Driver / Passenger Front
5#	2	DCB	Bar Bracket for Driver / Passenger Center
6#	2	DRB	Bar Bracket for Driver / Passenger Rear

PART LIST

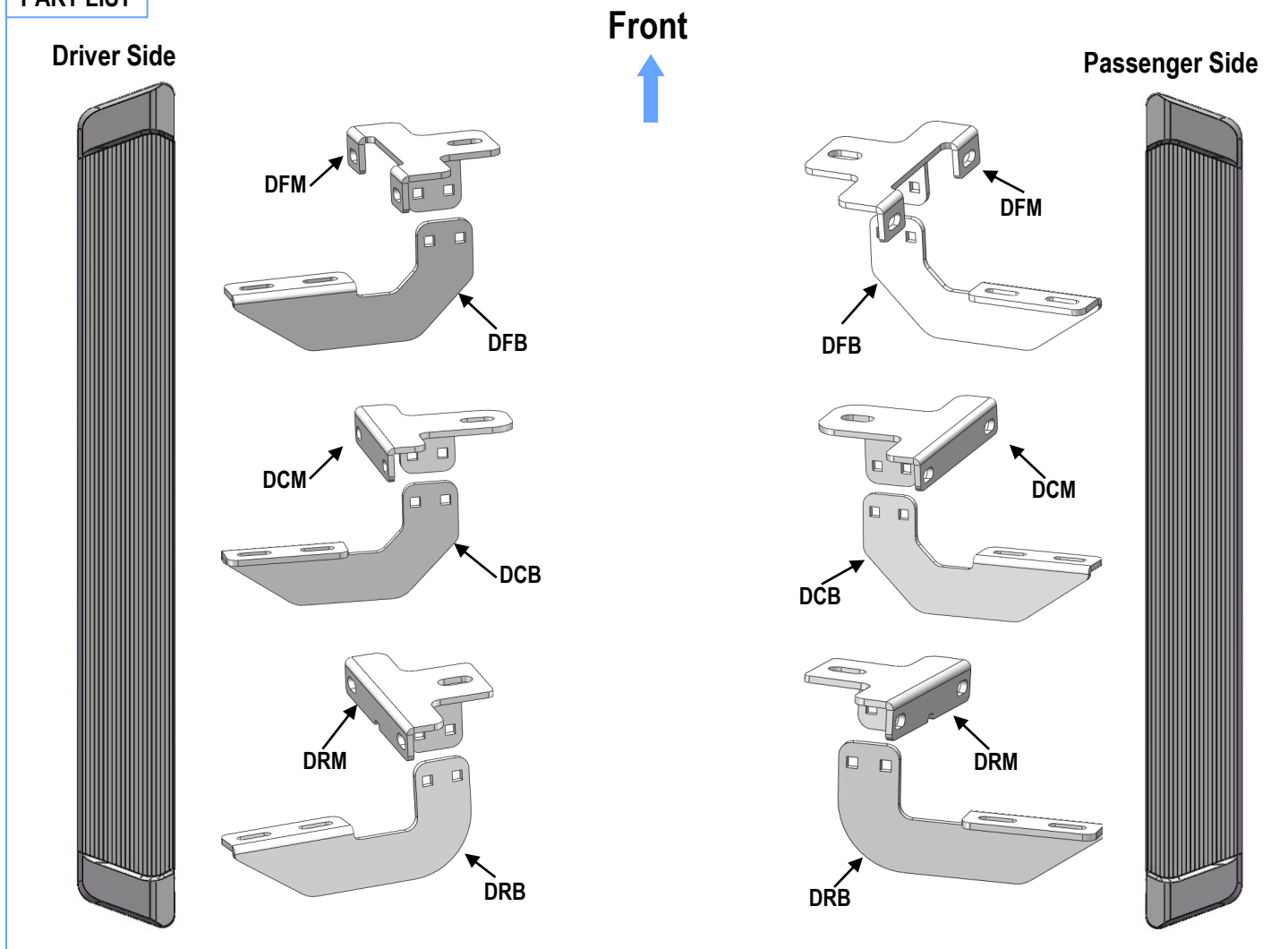



Hardware Package A (For Bracket Installation)

Item	QTY	Description	Item	QTY	Description
A1	6	M8X1.25-35 Hex Bolts	A6	12	M6X1 Nylon Lock Nuts
A2	6	M8 X-Large Flat Washers	A7	12	M8X1.25-25 Carriage Bolts
A3	6	M8 Lock Washers	A8	12	M8 Flat Washers
A4	12	M6X1-25 Hex Bolts	A9	12	M8X1.25 Nylon Lock Nuts
A5	24	M6 X-Large Flat Washers			

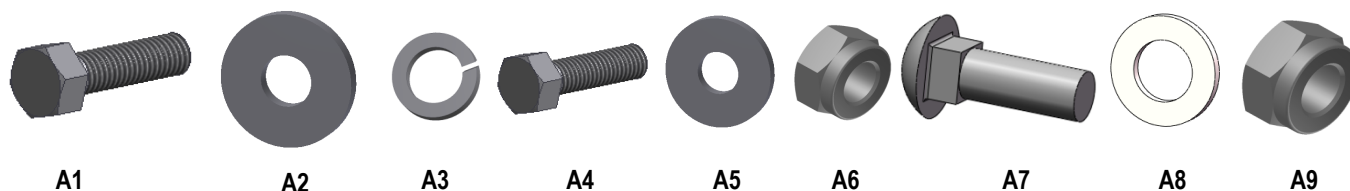

Hardware Package B (For Step Bar Installation)

Item	QTY	Description	Item	QTY	Description
B1	12	M6X1-20mm Square Head Bolts	B3	12	M6 Nylon Lock Nuts
B2	12	M6 Large Flat Washers			





STEP 1: Assemble Front Mounting Brackets

(1) Assemble Driver Front Mounting Bracket (DFM+DFB) (Fig 1) with:

- (2) A7 (M8X1.25-25 Carriage Bolts)
- (2) A8 (M8 Flat Washers)
- (2) A9 (M8X1.25 Nylon Lock Nuts)

(2) Repeat to Assemble the remaining (1) Mounting Brackets (DFM+DFB).

Note: All (2) Assembled Mounting Brackets (DFM+DFB) are Universal for Driver Front and Passenger Front.

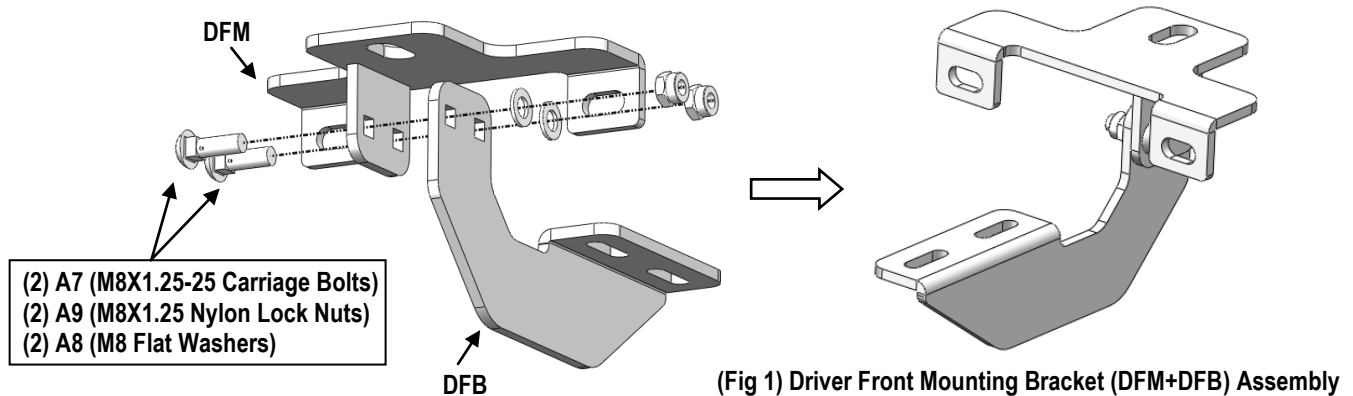

STEP 2: Assemble Center Mounting Brackets

(1) Assemble Driver Center Mounting Bracket (DCM+DCB) (Fig 2) with:

- (2) A7 (M8X1.25-25 Carriage Bolts)
- (2) A8 (M8 Flat Washers)
- (2) A9 (M8X1.25 Nylon Lock Nuts)

(2) Repeat to Assemble the remaining (1) Mounting Brackets (DCM+DCB).

Note: All (2) Assembled Mounting Brackets (DCM+DCB) are Universal for Driver Center and Passenger Center.

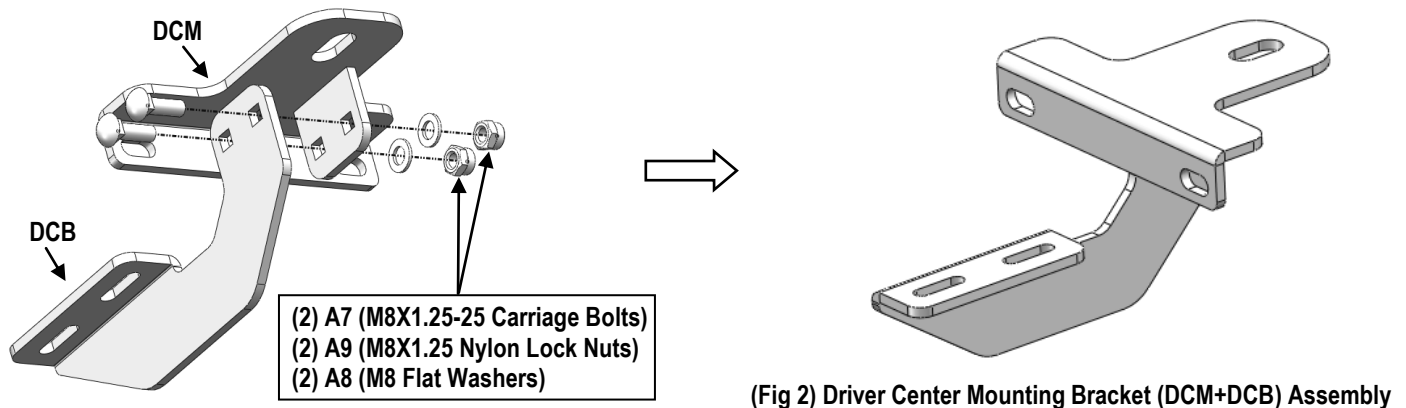



STEP 3: Assemble Rear Mounting Brackets

(1) Assemble Driver Rear Mounting Bracket (**DRM+DRB**) (**Fig 3**) with:

- (2) A7 (M8X1.25-25 Carriage Bolts)
- (2) A8 (M8 Flat Washers)
- (2) A9 (M8X1.25 Nylon Lock Nuts)

(2) Repeat to Assemble the remaining (1) Mounting Brackets (**DRM+DRB**).

Note: All (2) Assembled Mounting Brackets (DRM+DRS) are Universal for Driver Rear and Passenger Rear.

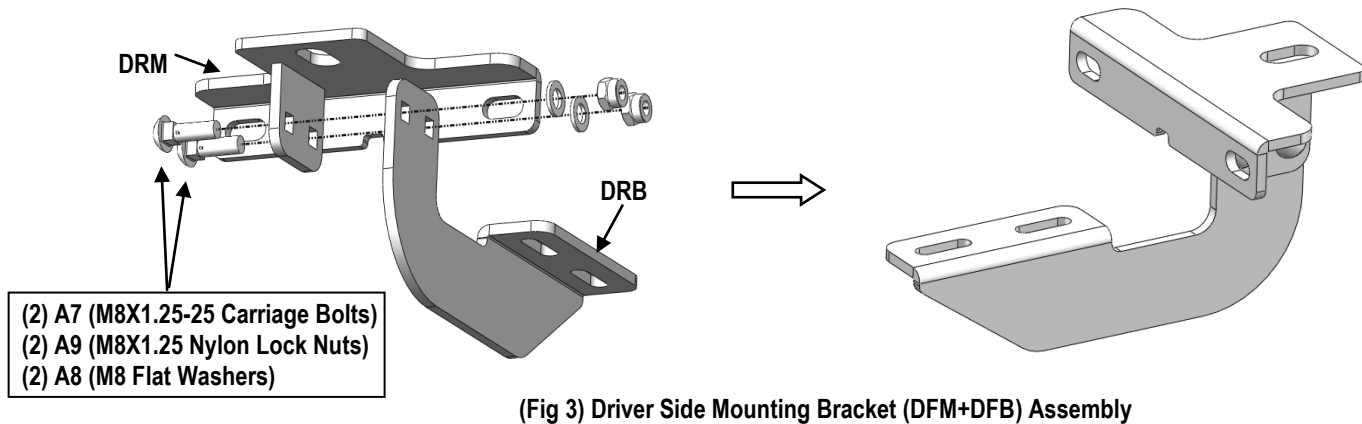

STEP 4: Locate Driver Side Mounting Positions

- Locate (3) mounting points on pinch weld of driver side. (**Fig 4**).
- Find (3) factory threaded mounting holes at the bottom of driver side floor. (**Figs 5-7**).

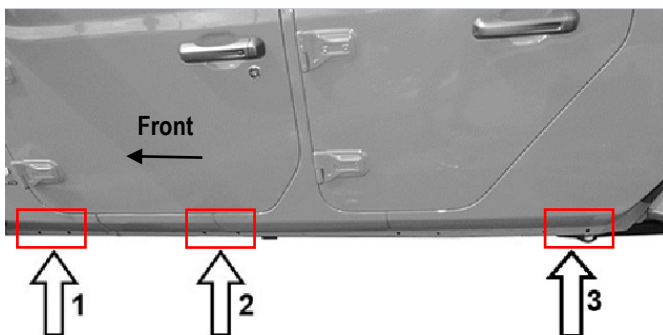

(Fig 4) Driver Side (3) Mounting Positions

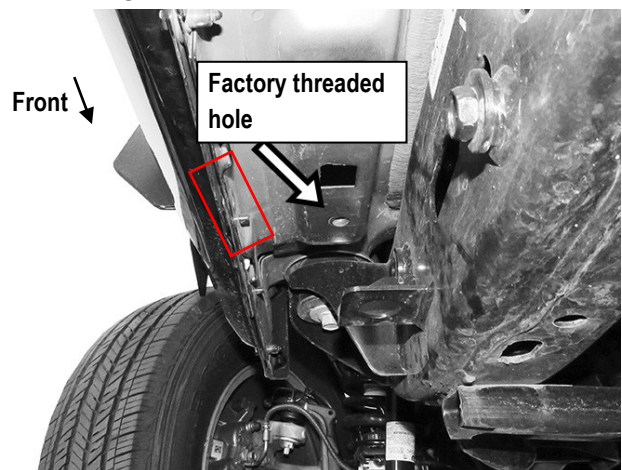

(Fig 5) Driver Side Front Mounting Position

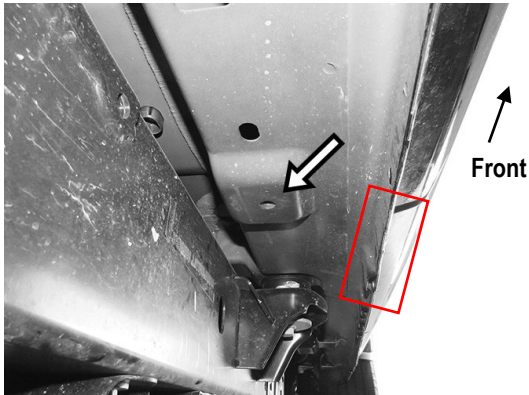

(Fig 6) Driver Side Center Mounting Position

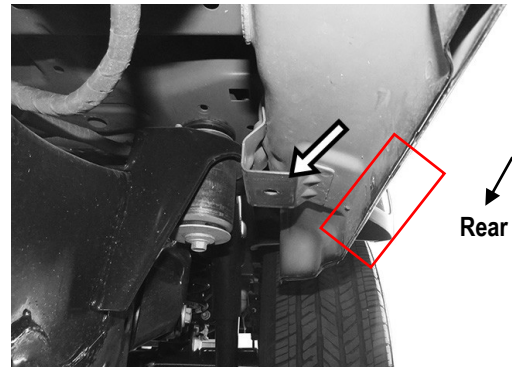

(Fig 7) Driver Side Rear Mounting Position

STEP 5: Install Driver Front Mounting Bracket

Attach the Assembled Driver Front Mounting Bracket (DFM+DFB) to the Driver Side Front Mounting Position (Figs 5&8) with:

- (2) A4 (M6X1-25 Hex Bolts)
- (4) A5 (M6 X-Large Flat Washers)
- (2) A6 (M6 Nylon Lock Nuts)
- (1) A1 (M8X1.25-35mm Hex Bolt)
- (1) A2 (M8 X-Large Flat Washer)
- (1) A3 (M8 Lock Washer)

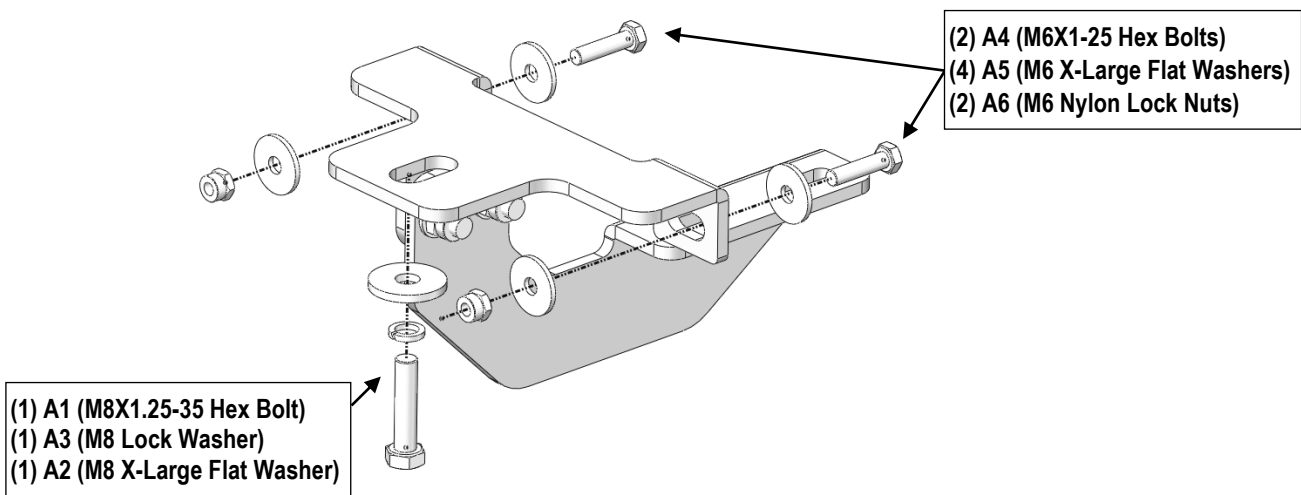

(Fig 8) Driver Front Mounting Bracket (DFM+DFB) Installation



STEP 6: Install Driver Center Mounting Bracket

Attach Assembled Driver Center Mounting Bracket (**DCM+DCB**) to the Driver Center Mounting Position (**Figs 6&9**) with:

- (2) A4 (M6X1-25 Hex Bolts)
- (4) A5 (M6 X-Large Flat Washers)
- (2) A6 (M6 Nylon Lock Nuts)
- (1) A1 (M8X1.25-35mm Hex Bolt)
- (1) A2 (M8 X-Large Flat Washer)
- (1) A3 (M8 Lock Washer)

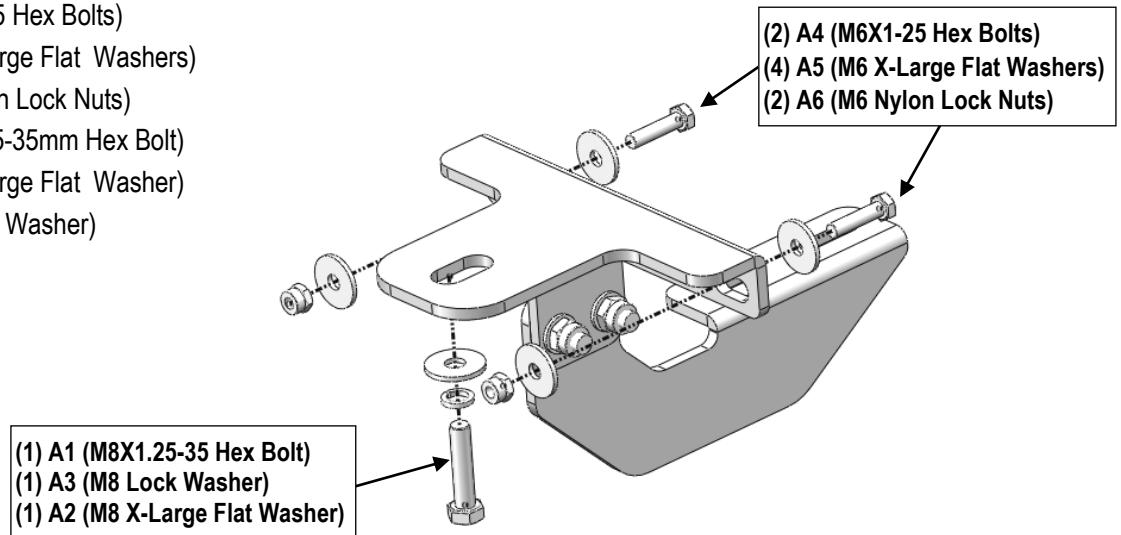

(Fig 9) Driver Center Mounting Bracket (DCM+DCB) Installation

STEP 7: Install Driver Rear Mounting Bracket

Attach Assembled Driver Rear Mounting Bracket (**DRM+DRB**) to the Driver Center Mounting Position (**Figs 7&10**) with:

- (2) A4 (M6X1-25 Hex Bolts)
- (4) A5 (M6 X-Large Flat Washers)
- (2) A6 (M6 Nylon Lock Nuts)
- (1) A1 (M8X1.25-35mm Hex Bolt)
- (1) A2 (M8 X-Large Flat Washer)
- (1) A3 (M8 Lock Washer)

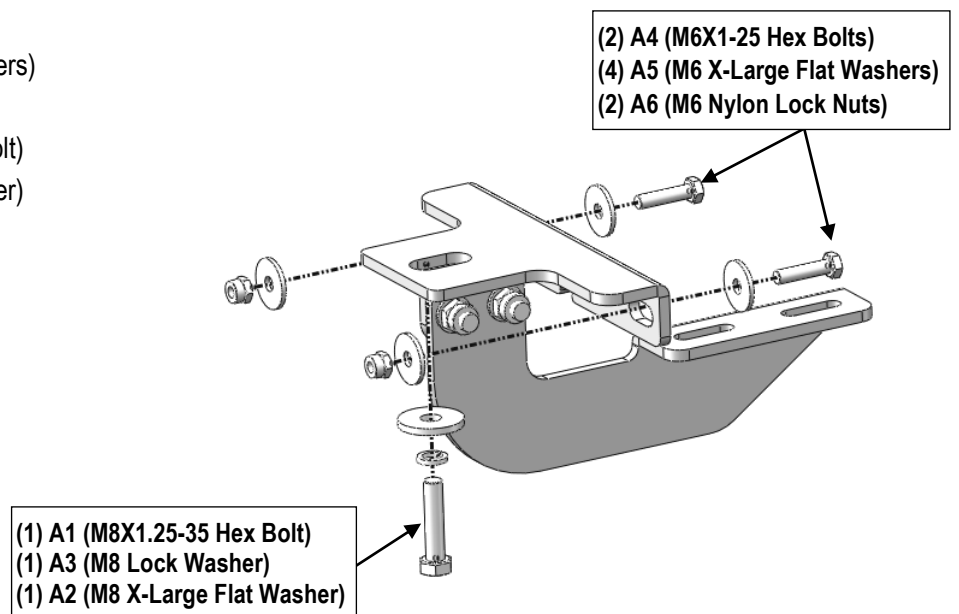

(Fig 10) Driver Rear Mounting Bracket (DRM+DRB) Installation



STEP 8: Driver Side Running Board Installation

Once all (3) Driver side mounting brackets are installed, then proceed to the Running Board installation (**Figs 11-12**).

- Select a Running Board. Slip (3) B1(M6X1-20mm Square Head Bolts) into each bottom channel (**Fig 11**).
- Carefully position the Running Board onto the (3) Mounting Brackets.
- Attach the Running Board to each Mounting Bracket with (**Fig 12**):
 - (2) B1 (M6X1-20mm Square Head Bolts)
 - (2) B2 (M6 Large Flat Washers)
 - (2) B3 (M6 Nylon Lock Nuts)

Note: Do not fully tighten hardware at this time.

IMPORTANT: Do not slide the Running Board on the Brackets or the bottom surface of the board will be damaged.

M6X1-20mm Square Head Bolts

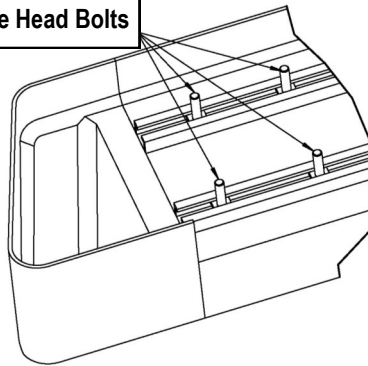

(Fig 11) Slip M6X1-20mm Square Head Bolts Into The Bottom Channels

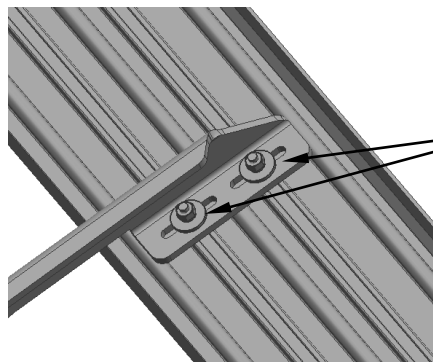

(2) B1 (M6X1-20mm Square Head Bolts)
(2) B2 (M6 Large Flat Washers)
(2) B3 (M6 Nylon Lock Nuts)

(Fig 12) Running Board Installed Onto Mounting Bracket



STEP 9: Driver Side Running Board Adjustment

- Level and adjust the Running Board properly.
- Tighten all 6mm hardware with 6-7 ft-lbs torque.
- Tighten all 8mm hardware with 16-18 ft-lbs torque.

Important: Please follow the recommended Tightening Torques shown in the table on page 1.

Don't over tighten, or the nuts/bolts will be damaged.

STEP 10: The Other Side Running Board Installation

Move to the other side of the vehicle. Repeat **Steps 4-9** for the other Running Board installation.

Attention

- Do periodic inspections to the installation to make sure that all hardware is secure and tight.
- In order to protect your bars/boards, please use mild soap/non-abrasive products for cleaning only.