



iBoard® Series

INSTALLATION INSTRUCTIONS

PART#: IB-R002

BEFORE INSTALLATION

REMOVE CONTENTS FROM BOX. VERIFY ALL PARTS ARE PRESENT. READ INSTRUCTIONS CAREFULLY BEFORE STARTING INSTALLATION. ASSISTANCE IS RECOMMENDED. THANK YOU FOR CHOOSING OUR PRODUCT!

These instructions are provided for reference only. We strongly recommend installation by a professional installer for the best results. We are not responsible for any damage caused during installation.

*ROCKER PANEL MOUNT

*DRILLING REQUIRED

* HOLE ENLARGED MAY BE REQUIRED

Torque Value

Fastener Size	Tightening Torque (ft-lbs)	Required
6mm	6-7	√
8mm	16-18	√
10mm	31-32	√
12mm	56-58	X
14mm	92-94	X



Scan for
Installation Video

Mounting Bracket List							
Item	QTY	Bracket Label	Description	Item	QTY	Bracket Label	Description
1#	2	DFM	Mounting Bracket for Driver Front/ Rear	4#	2	PFM	Mounting Bracket for Passenger Front / Rear
2#	1	DCM	Mounting Bracket for Driver Center	5#	1	PCM	Mounting Bracket for Passenger Center
3#	3	DRS	Support Bracket for Driver Side	6#	3	PRS	Support Bracket for Passenger Side

PART LIST

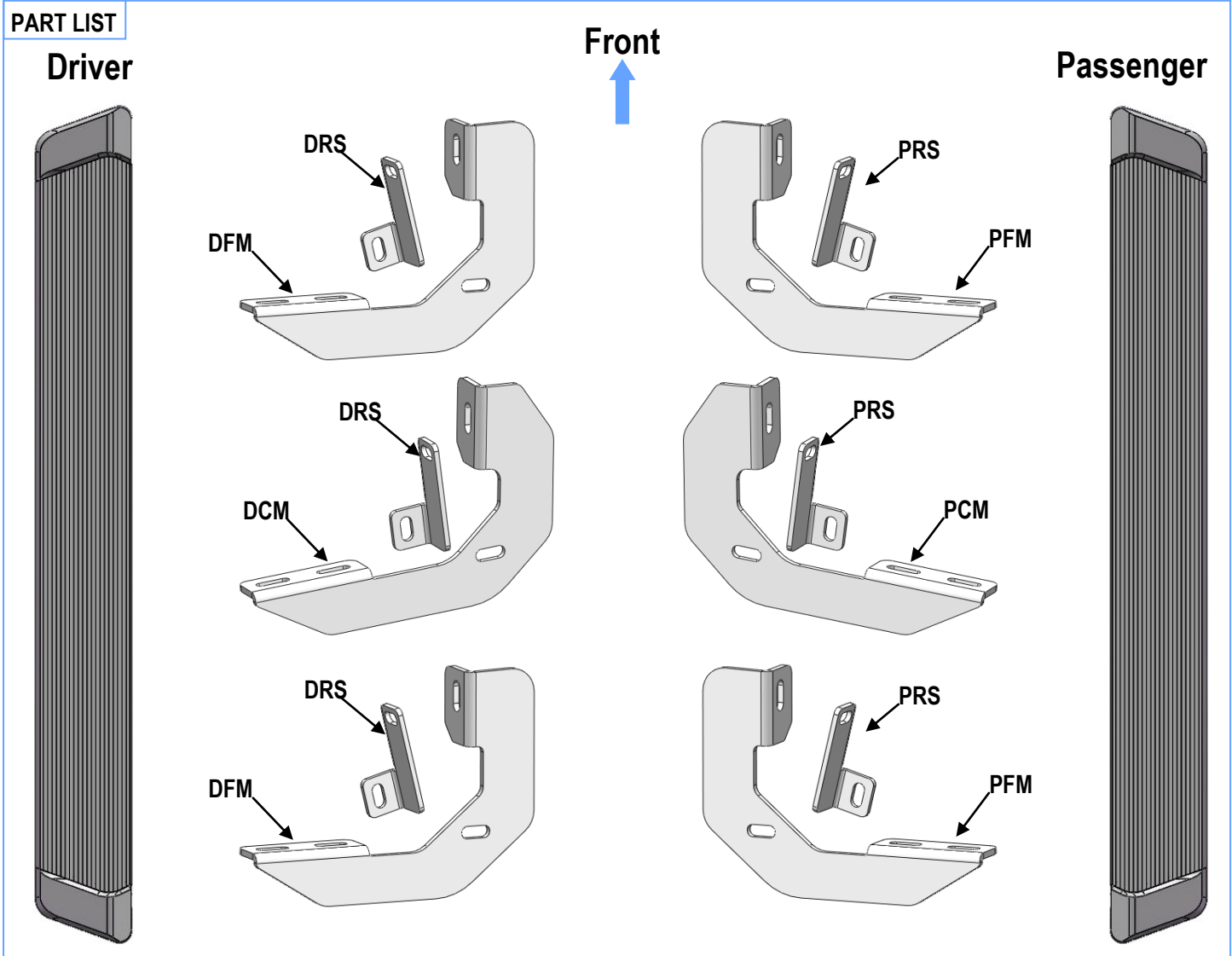



Scan for
Installation Video

Hardware Package A (For Bracket Installation)					
Item	QTY	Description	Item	QTY	Description
A1	6	M10X35 Bolt Plates	A6	12	M8X1.25-25mm Hex Bolts
A2	6	M10 Plastic Washers	A7	12	M8 Large Flat Washers
A3	6	M10 Large Flat Washers	A8	12	M8 Flat Washers
A4	6	M10 Lock Washers	A9	12	M8 Nylon Lock Nuts
A5	6	M10 Hex Nuts			

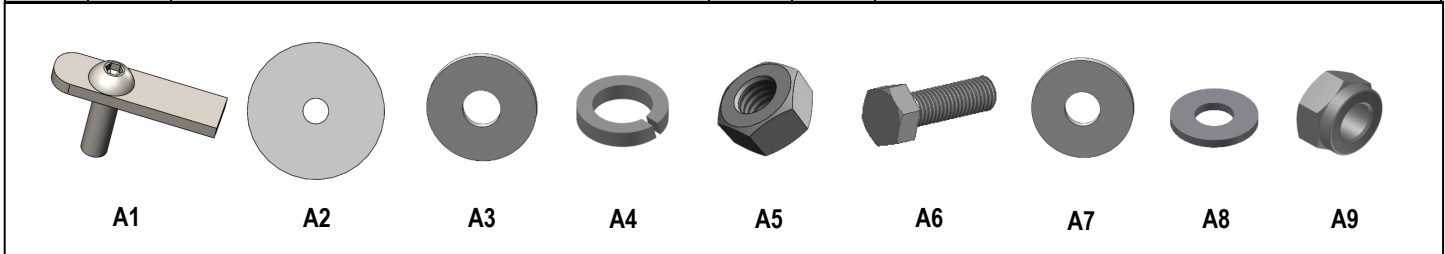

Hardware Package B (For Running Board Installation)					
Item	QTY	Description	Item	QTY	Description
B1	12	M6X1-20mm Square Head Bolts	B3	12	M6 Nylon Lock Nuts
B2	12	M6 Large Flat Washers			





STEP 1: Driver Side Mounting Brackets Assembly

1. Assemble Driver Front Mounting Bracket (DFM+ DRS) (Fig 1) With:

- (1) A6 (M8X1.25-25mm Hex Bolt)
- (2) A7 (M8 Large Flat Washers)
- (1) A9 (M8X1.25 Nylon Lock Nut)

Note: Driver Front Mounting Bracket (DFM+DRS) and Driver Rear Mounting Bracket (DFM+DRS) are universal.

2. Repeat to assemble Driver Center Mounting Bracket (DCM+DRS) (Fig 2).

Note: Do not fully tighten hardware at this time.

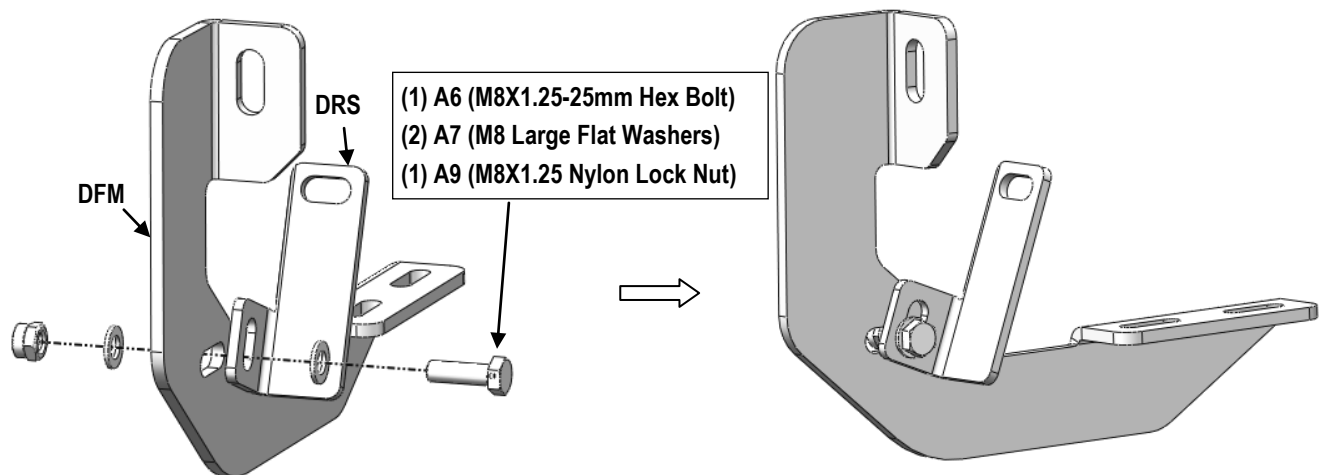

(Fig 1) Driver Front Mounting Bracket (DFM+DRS) Assembly

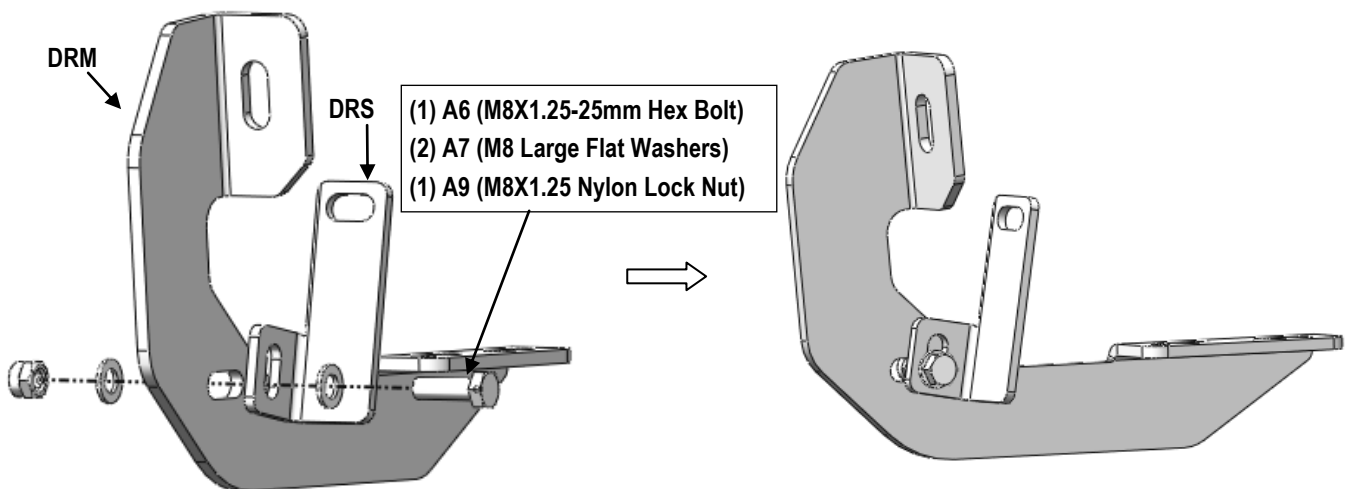

(Fig 2) Driver Center Mounting Bracket (DCM+DRS) Assembly



STEP 2: Locate Driver Side Front Mounting Location

- Locate the (2) oval holes on the inner body panel on Driver Front Mounting Location. Remove the Sealing tapes covering the 2nd factory hole, (**Fig 3**).
- Thread (1) A2 (M10 Plastic Washer) onto (1) A1 (M10X40 Bolt Plate).
- Insert the (1) A1 (M10X40 Bolt Plate) into the factory hole on the body panel.
- Thread the A2 (M10 Plastic Washer) down against the sheet metal to hold the bolt plate in place, (**Fig 4**).

NOTE: The Plastic Washer is designed to keep the Bolt Plate from falling into the body panel during bracket installation.

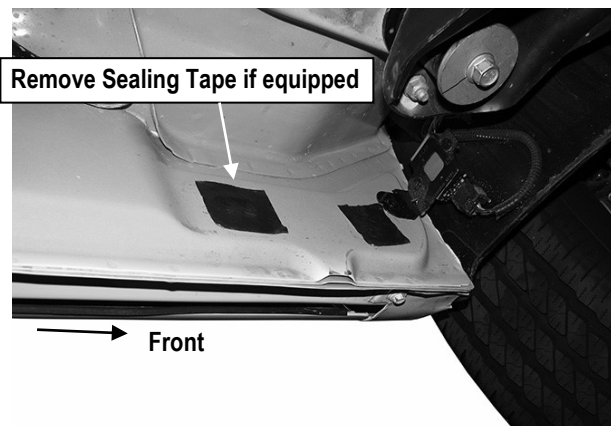

(Fig 3) Driver Side Front Mounting Location

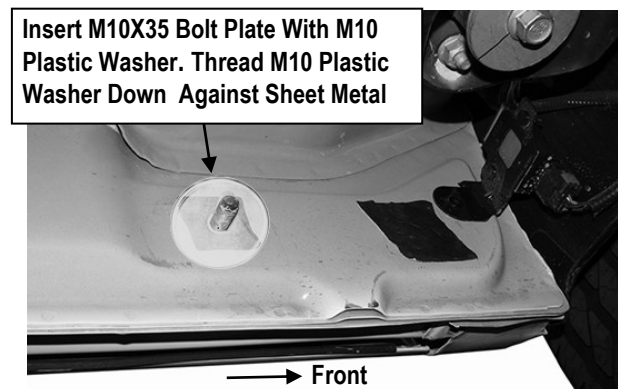

(Fig 4) M10X35 Bolt Plate Installation
(on Driver Side Front Mounting Location)

STEP 3: Driver Front Mounting Bracket Installation

1. Attach the Assembled Driver Front Mounting Bracket (**DFM+DRS**) onto the installed A1 (M10X35 Bolt Plate) on Driver Front Mounting Location (**Fig 5**) with:

- (1) A3 (M10 Large Flat Washer)
- (1) A4 (M10 Lock Washer)
- (1) A5 (M10 Hex Nut)

NOTE:

Place the flat end of the Support Bracket up against the pinch weld at the bottom of the body panel.

Don't fully tighten hardware at this time.

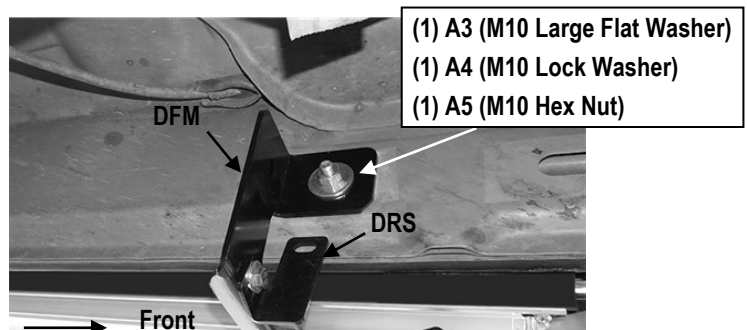

(Fig 5) Driver Front Mounting Bracket Installed



STEP 4: Driver Center & Rear Mounting Brackets Installation

- Move to the Driver Side Center & Rear Mounting Locations. (Figs 6 & 7).
- Repeat **Steps 2-3** to install the Driver Center / Rear Mounting Brackets. (Figs 8 & 9).

Note: Driver Front Mounting Bracket (DFM+DRS) and Driver Rear Mounting Bracket (DFM+DRS) are universal.
Do not fully tighten hardware at this time.

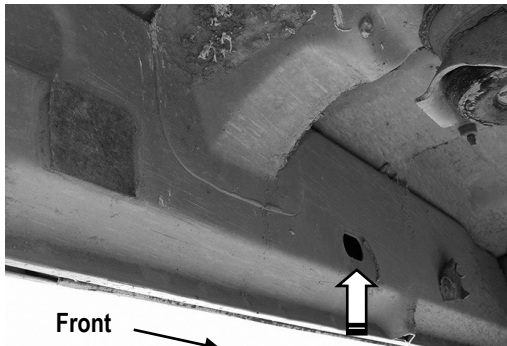

(Fig 6) Driver Side Center Mounting Location

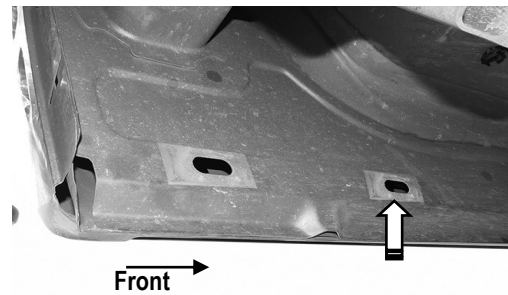

(Fig 7) Driver Side Rear Mounting Location

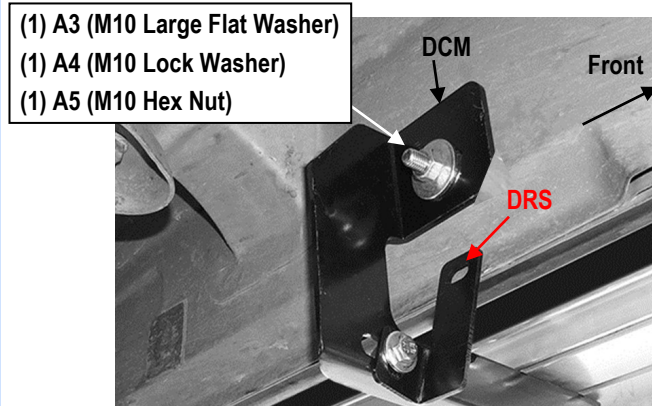

(Fig 8) Driver Center Mounting Bracket Installation

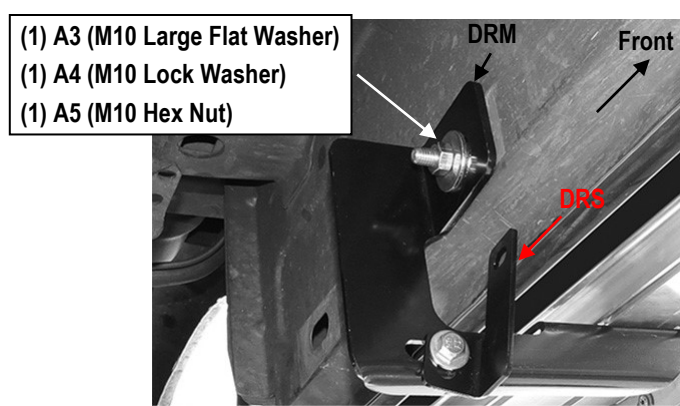

(Fig 9) Driver Rear Mounting Bracket Installation



STEP 5: Driver Side Running Board Installation

Once all (3) mounting brackets are installed, then proceed to the Running Board installation.

(1) Select a Running Board. Slide (3) B1 M6X1-20mm Square Head Bolts into each bottom channel (**Fig 10**).

(2) Carefully position the Running Board onto the (2) Mounting Brackets.

(3) Attach the Running Board to each Mounting Bracket (**Fig 11**) with

- (2) B1 (M6X1-20mm Square Head Bolts)
- (2) B2 (M6 Large Flat Washers)
- (2) B3 (M6 Nylon Lock Nuts)

Note: Do not slide the Running Board on the Brackets or the bottom surface of the board will be damaged.

M6X1-20mm Square Head Bolts

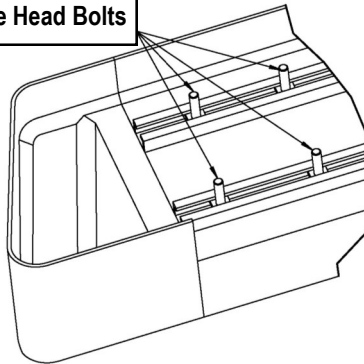

(Fig 10) Slip M6X1-20mm Square Head Bolts Into The Bottom Channels

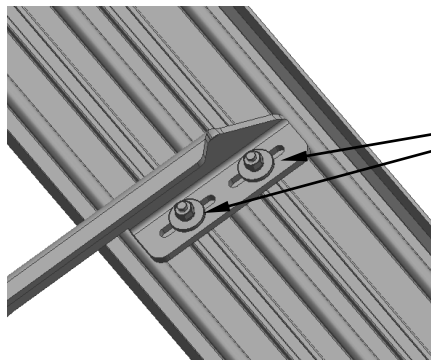

(2) B1 (M6X1-20mm Square Head Bolts)
(2) B2 (M6 Large Flat Washers)
(2) B3 (M6 Nylon Lock Nuts)

(Fig 11) Running Board Installed Onto Mounting Bracket



STEP 6: (3) Driver Rear Support Brackets (DRS) Installation

1. Move back to the installed (3) Driver Rear Support Brackets(**DRS**).
2. Adjust Driver Rear Support Brackets(**DRS**) up or down to level the Running Board.
3. Mark the slot location onto the pinch weld. (Fig 12).
IMPORTANT: Make sure do not mark too close to the edge of the pinch weld.
4. Remove the Driver Rear Support Brackets(**DRS**)
5. Drill (3) 5/16" (or 8mm) through holes on the pinch weld for all (3) Driver Rear Support Brackets(**DRS**) .
IMPORTANT: Make sure do not drill too close to the edge of the pinch weld.
6. Re-attach each Driver Rear Support Brackets(**DRS**) to the back of the pinch weld (Fig 13) with :
 - (1) A6 (M8X1.25-25mm Hex Bolt)
 - (2) A8 (M8 Flat Washers)
 - (1) A9 (M8X1.25 Nylon Lock Nut)

Level the running boards and fully tighten all hardware.

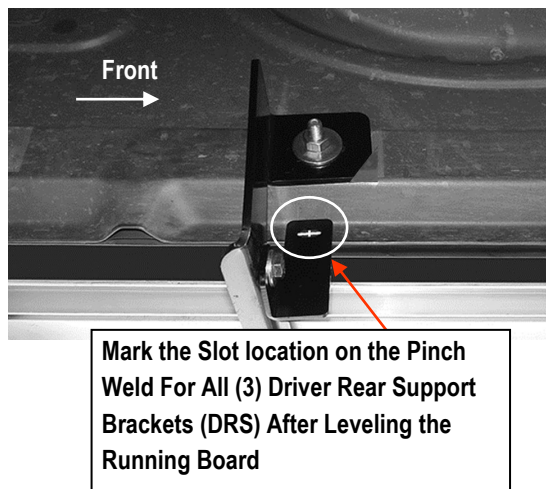

(Fig 12) Example for Marking Slot Location of Driver Support Bracket on Pinch weld

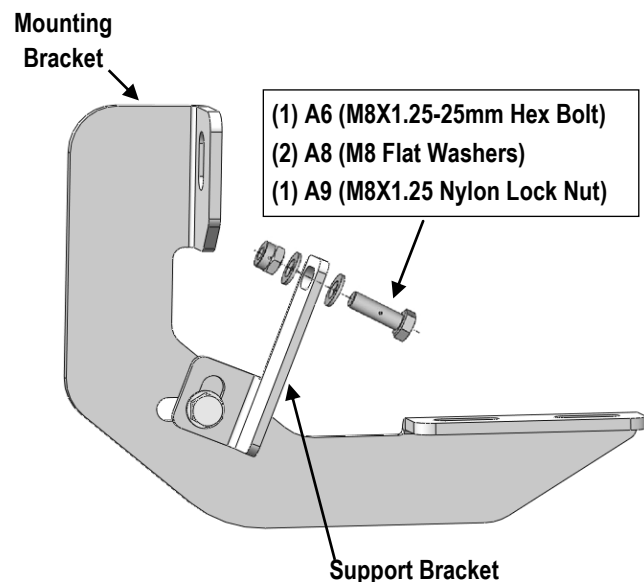

(Fig 13) Driver Rear Support Bracket (DRS) Installation

STEP 7: Driver Side Running Board Adjustment

- Level and adjust the Running Board properly.
- Tighten all 6mm hardware with 6-7 ft-lbs torque ,8mm hardware with 16-18 ft-lbs torque and 10mm hardware with 31-32 ft-lbs torque



STEP 8: The Other Side Running Board Installation

Repeat **Steps 1-7** for the Other Side Running Board Installation.
And then installation is completed!!!

Attention

Do periodic inspections to the installation to make sure that all hardware is secure and tight.
In order to protect your bars/boards, please use mild soap/non-abrasive products for cleaning only.