



# iBoard® Series

## INSTALLATION INSTRUCTIONS

**PART#: IB-P196L Y&H**

### BEFORE INSTALLATION

REMOVE CONTENTS FROM BOX. VERIFY ALL PARTS ARE PRESENT. READ INSTRUCTIONS CAREFULLY BEFORE STARTING INSTALLATION. ASSISTANCE IS RECOMMENDED. THANK YOU FOR CHOOSING OUR PRODUCT!

**\*ROCKER PANEL MOUNT**

**\*NO DRILLING REQUIRED/CUTTING MAYBE REQUIRED**

### Torque Value

Fastener Size	Tightening Torque (ft-lbs)	Required
6mm	6-7	X
8mm	16-18	√
10mm	31-32	X
12mm	56-58	√
14mm	92-94	X



Scan for  
Installation Video

Mounting Bracket List			
Item	QTY	Bracket Label	Description
1#	3	DFM	Mounting Bracket for Driver Front/Center/Passenger Center
2#	1	DRM	Mounting Bracket for Driver Rear
3#	1	DRB	Bar Bracket for Driver Rear
4#	1	PFM	Mounting Bracket for Passenger Front
5#	1	PRM	Mounting Bracket for Passenger Rear
6#	1	PRB	Bar Bracket for Passenger Rear

#### PART LIST

#### Driver Side Step Bar

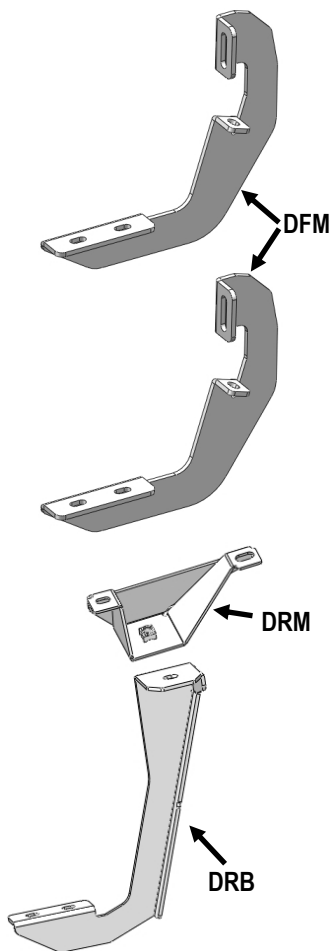

Front



#### Passenger Side Step

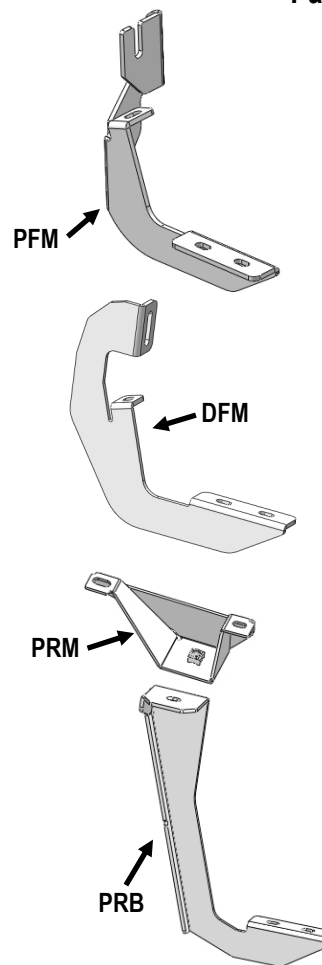



Scan for  
Installation Video

### Hardware Package A (For Bracket Installation)

Item	QTY	Description	Item	QTY	Description
A1	2	Sleeve Washers	A8	2	M12 Hex Nuts
A2	4	M12 Spacers	A9	2	M8X1.25-35mm Hex Bolts
A3	2	M12X35 Bolt Plates	A10	8	M8X1.25-25mm Hex Bolts
A4	2	M12 Plastic Washers	A11	10	M8 Large Flat Washers
A5	2	M12X1.75-65mm Hex Bolts	A12	10	M8 Lock Washers
A6	4	M12 Flat Washers	A13	8	M8 Clip Nuts
A7	4	M12 Lock Washers			

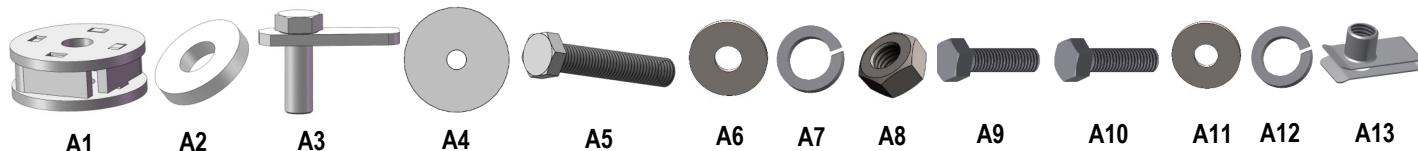

### Hardware Package B (For Stainless Steel Step Bar Installation)

Item	QTY	Description	Item	QTY	Description
B1	12	M8X1.25-35mm Carriage Bolts	B3	12	M8 Nylon Lock Nuts
B2	12	M8 Large Flat Washers	B4	6	Sliders (Packed with Step Bars)





## STEP 1

Start the installation from the driver side of the vehicle. Locate the mounting tabs along the bottom edge of the body, (pinch weld). Mounting brackets will bolt to the mounting tabs. Directly above each tab, there is another upper mounting location on the inner side of the body panel. (Fig 1).

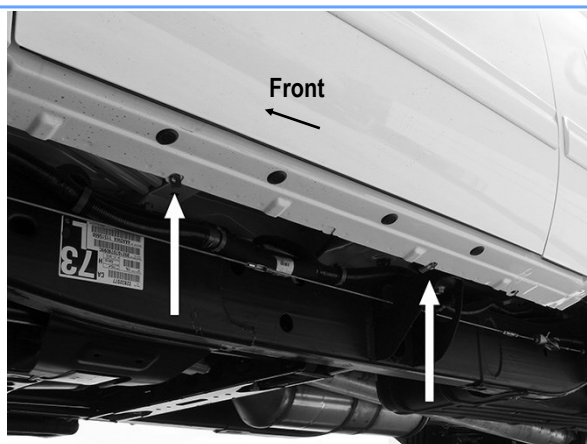

(Fig 1) Driver Side Mounting Locations

## STEP 2

Determine the correct procedure for your model/year and each Bracket location.

### A. Lower mounting location on the edge of the pinch weld

#### a) Flat tab on pinch weld with factory installed weld nut:

Thread the M8X1.25-25mm Hex Bolt into the welded nut to clear paint from threads as required, (Fig 2).

#### b) Flat tab on pinch weld with hole (Fig 3,4) :

Select (1) A8 (M8 Clip Nut). Slide the Clip Nut over the tab with the nut facing up behind the tab. Line up threaded nut with hole in tab. Repeat this **Step** for Driver Rear mounting location.

### B. Upper mounting location on the inner side of the body panel:

**a) Models with factory installed threaded insert in body panel:** Thread M8X1.25-25mm Hex Bolt into the threaded

insert to clear paint as required, (Fig 2).

#### b) Models with large and small holes on the body panel (Fig 3, 4):

Remove the rubber plug from the larger hole. Select (1) M8 Clip Nut. Insert the Clip Nut into the larger hole with the thread facing inner side.

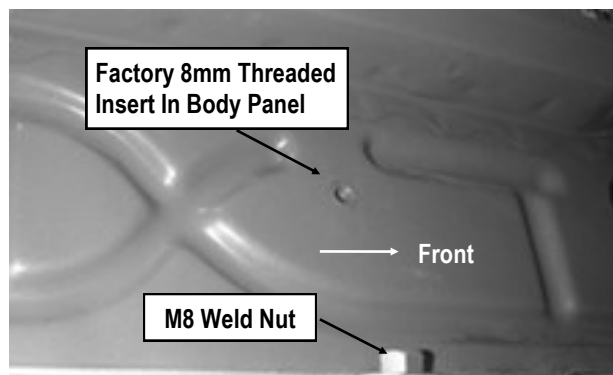

(Fig 2) Driver Side Front Mounting Location

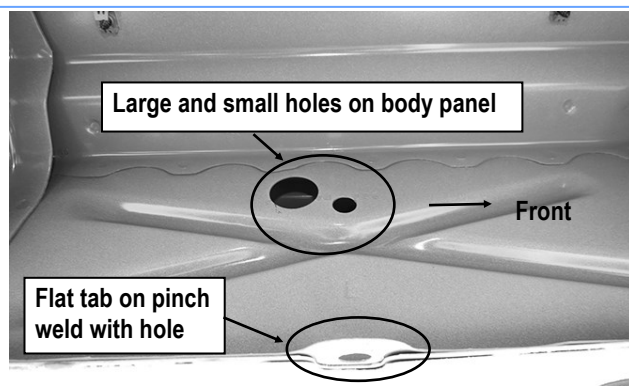

(Fig 3) Driver Side Front Mounting Location  
(Flat tab on Pinch Weld with hole)

## STEP 3

Select (1) Driver Front Mounting Bracket (**DFM**), bolt the Mounting Bracket to the installed M8 Clip Nuts and/or the factory threaded holes on Driver Side Front Mounting Location with (2) A10 (M8X1.25-25 Hex Bolts), (2) A12 (M8 Lock Washers) and (2) A11 (M8 Large Flat Washers), (Fig 4). Do not fully tighten the hardware. Repeat to install remaining Driver Center Mounting Bracket (**DFM**). **Note: All (3) DFM's are Universal.**

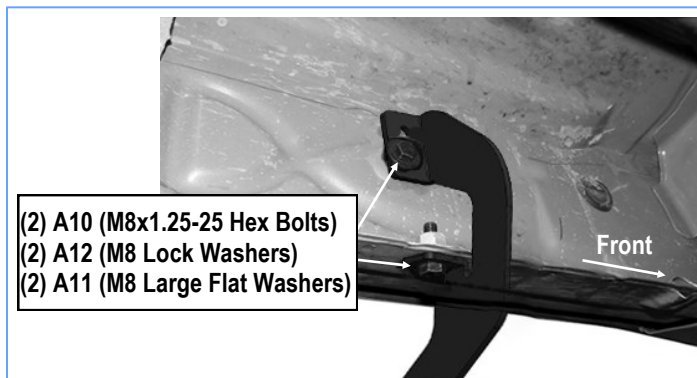

(Fig 4) Driver Front/Center Mounting Bracket Installed

## STEP 4

Move to Driver Side Rear Mounting location, directly behind the cab, underneath the bed locate the beam that mounts the bed to the frame. There will be 2 pre-existing bolts, remove both factory M8 and M12 hardware (**Fig 5A**). Select Driver Rear Mounting Bracket (**DRM**), bolt the Support Bracket with include (1) A9 (M8X1.25-35mm Hex Bolt), (1) A12 (M8 Lock Washer), (1) A11 (M8 Flat Washer), and (1) A2 (M12 Spacer). Do not fully tighten hardware at this time.

**07-17 Models:** Attach the Driver Rear Mounting Bracket (**DRM**) with Re-used M12 factory bolts, (**Fig 5B**).

**18-Up Models:** Attach the Driver Rear Mounting Bracket (**DRM**) with (1) A3 (M12X35 Bolt Plate), (1) A4 (M12 Plastic Washer), (1) A6 (M12 Flat Washer), (1) A7 (M12 Lock Washer) and (1) A8 (M12 Hex Nut). (**Fig 5C**).

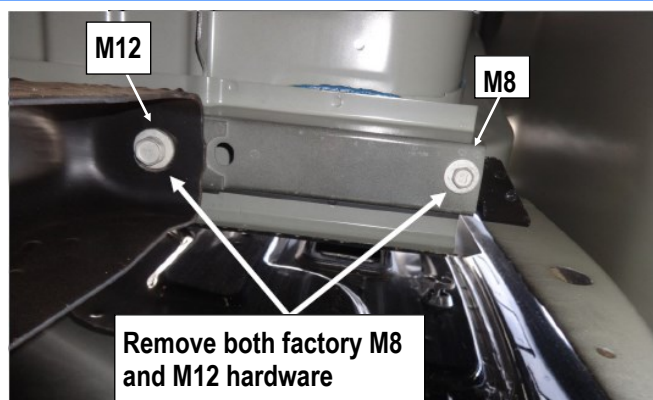

(Fig 5A) Driver Side Rear Mounting Location

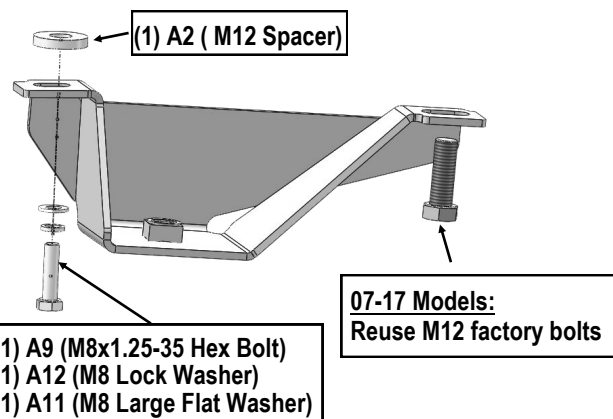

(Fig 5B) Driver Rear Support Bracket Installation

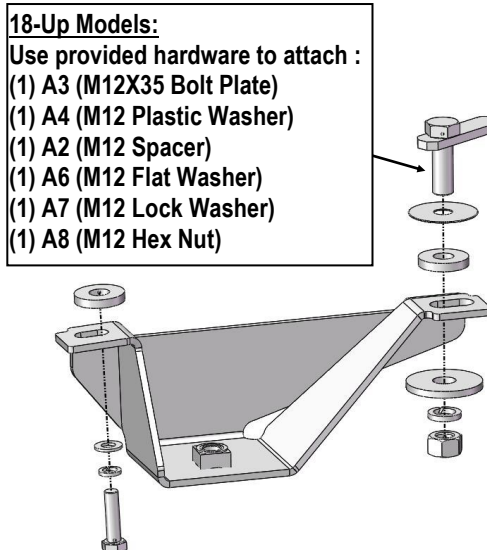

(Fig 5C) Driver Rear Support Bracket Installation

## STEP 5

Select (1) Driver Rear Bar Bracket (**DRB**), attach it to the installed Driver Rear Mounting Bracket (**DRM**) with (1) A5 (M12X1.75-65mm Hex Bolt), (1) A7 (M12 Lock Washer), (1) A1 (Sleeve Washer) and (1) A6 (M12 Flat Washer), (**Fig 6**). Do not fully tighten hardware at this time.

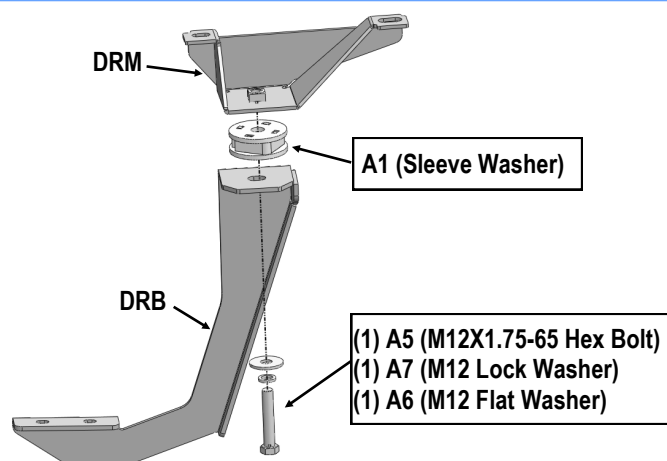

(Fig 6) Driver Rear Mounting Brackets Assembly

## STEP 6

Once all (3) Driver side mounting brackets are installed, then proceed to the Step Bar installation. (Figs 7 & 8)

- (1) Select (1) B4 (Slider) and (2) B1 (M8X1.25-35 Carriage Bolts);
- (2) Install (2) B1 (M8X1.25-35 Carriage Bolts) in (1) B4 (Slider).
- (3) Slide the Slider (with carriage bolts) to the **Step Bar**.
- (4) Repeat to install the other (1) B4 (sliders) to the step bar.
- (5) Attach the Step Bar (with the Sliders) onto the installed mounting brackets. Position the Sliders to the installed brackets. Secure the Step Bar to the installed Brackets by using (6) B2 (M8 Flat Washers) and (6) B3 (M8 Nylon Lock Nuts) and (3) B4 (Sliders), (Fig 8). Do not fully tighten hardware at this time.

**Note:** The Sliders are packed with the Mounting Bracket.

## STEP 7

Move to the passenger side of the vehicle. On the passenger side, determine if the vehicle is equipped with a plastic diesel exhaust fluid (DEF) tank, (Fig 9 & 10).

**Models without DEF tank, skip to Step 8.**

**Models with DEF tank:** The tank sits close to the side of the body. With specialized tools, the Passenger Front Mounting Bracket can be installed but room is limited. It may be easier to drop the tank down to access the inner side of the body panel for bracket installation. Tank will not need to be removed, only dropped down for access to mounting location.

**IMPORTANT:** If tank is full, it will be very heavy and assistance is highly recommended to avoid injury or damage to the vehicle or the tank. It is recommended that installation is performed when the DEF tank is low on fluid before dropping the tank.

- a. **For 07-16 Models:** with plastic lower tray under the tank, remove the (3) hex bolts attaching the tray to the frame, (Fig 9), and remove the tray. **For 2017-Up 2500/3500 models:** Remove the (4) hex bolts attaching the plastic cover to DEF tank, (Fig 10A) and remove the plastic cover, (Fig 10B).
- b. Release the tank filler hose. Release the plug for the sending unit on the top of the tank.
- c. Support the tank with a floor jack. Place a smooth flat surface, (wooden block for example), between the floor jack and the tank to avoid damaging the plastic tank. Do not push up on the tank; only support the weight of the tank with the jack.
- d. Remove the (2) bolts securing the tank straps to the vehicle, (Fig 11). Tilt the straps to release from the brackets. Slowly lower the tank until the top of the tank is almost visible. Use blocks or stands to support the tank while installing the front Brackets.
- e. Proceed to **Step 8**.



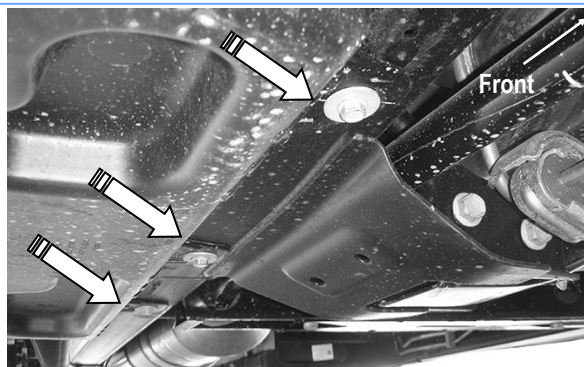
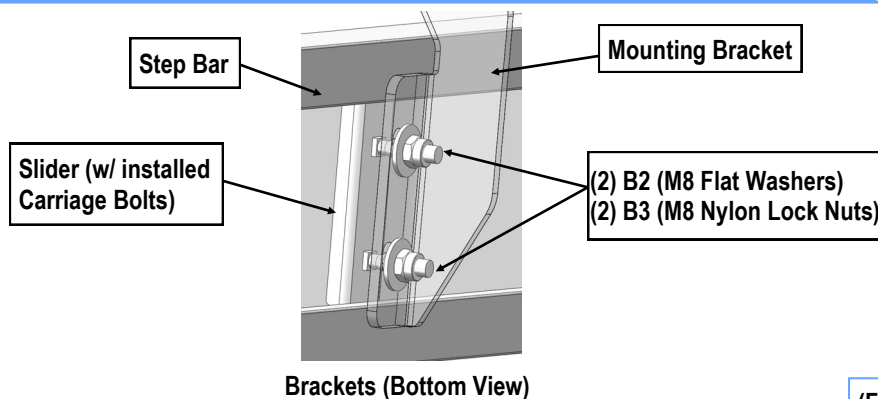
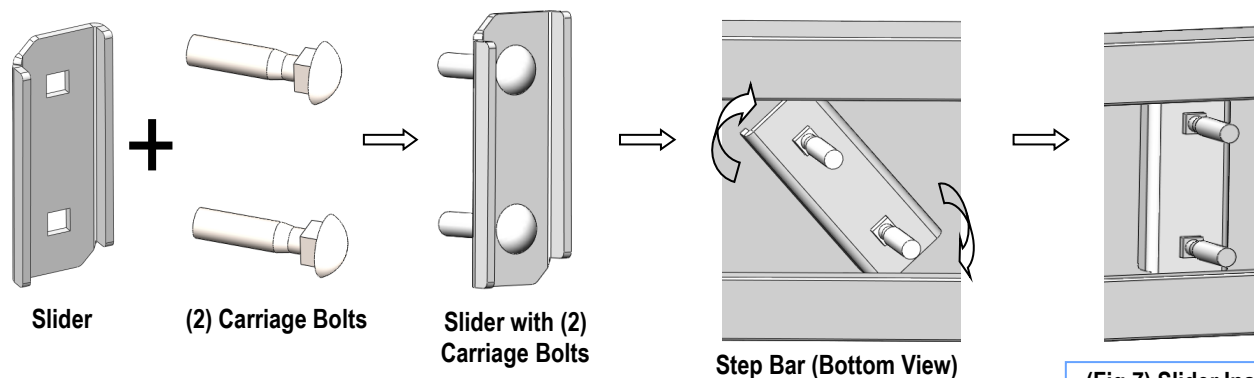

(Fig 9) 07-16 Passenger/Right front pictured with DEF tank cover.  
Remove (3) hex bolts to remove cover

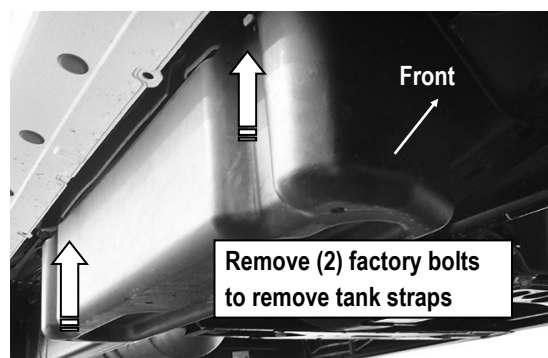

(Fig 10) Passenger side 07-16 DEF tank and cover



Scan for  
Installation Video

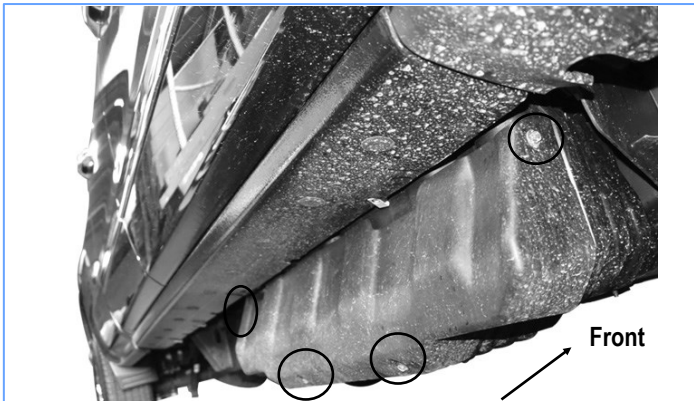

(Fig 11A) 17-on Passenger side pictured with DEF plastic tank cover. Remove (4) hex bolts to remove plastic cover



(Fig 11B) 17-on Passenger side DEF cover removed

## STEP 8

Locate the first tab on the edge of the pinch weld, attach the Passenger Front Mounting Bracket (PFM) to the pinch weld and upper body panel (Fig 12 & 13):

- Models with flat tab and hole:** see Fig 12. Leave loose at this time.
- Models with weld-nut:** see Fig 13. Leave loose at this time.

**Models With Hole :**  
(2) A10 (M8x1.25-25 Hex Bolts)  
(2) A12 (M8 Lock Washers)  
(2) A11 (M8 Large Flat Washers)  
(2) A13 (M8 Clip Nuts)

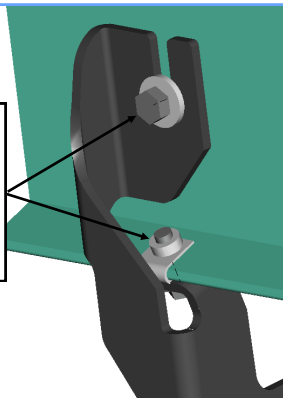

(Fig 12) Passenger Front Mounting Bracket Installed (example)

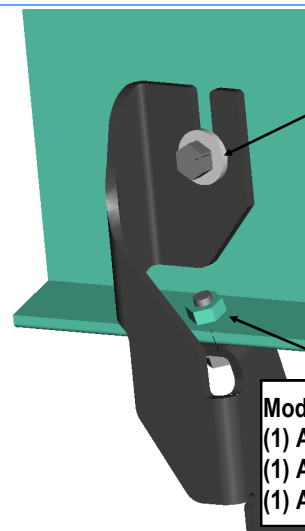

**Models With 8mm Threaded Insert In Body Panel:**  
(1) A10 (M8x1.25-25 Hex Bolt)  
(1) A12 (M8 Lock Washer)  
(1) A11 (M8 Large Flat Washer)

**Models With Weld Nut On Pinch Weld:**  
(1) A10 (M8x1.25-25 Hex Bolt)  
(1) A12 (M8 Lock Washer)  
(1) A11 (M8 Large Flat Washer)

(Fig 13) Passenger Front Mounting Bracket Installation (Weld Nut If Equipped-Also See Fig 2)

## STEP 9

Repeat **Steps 4-5** to install the Passenger Rear Mounting Bracket and Support Bracket.

**2017-up 2500/3500 DEF tank models:** Locate the rear tab bracket location along the bottom edge of the body, (pinch weld), (Fig 14). Hold the DEF cover in place and mark the Rear Bracket location onto the cover, (Fig 15). Use a sharp knife or hacksaw blade to carefully cut a slot in the plastic cover to clear the Rear Bracket, (Fig 16). Remove as little plastic as possible.

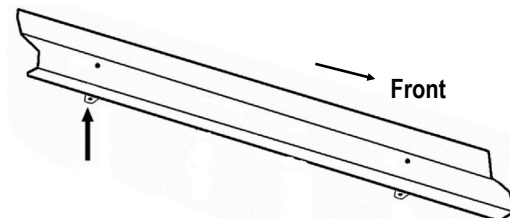

(Fig 14) Passenger Side Rear Mounting Location



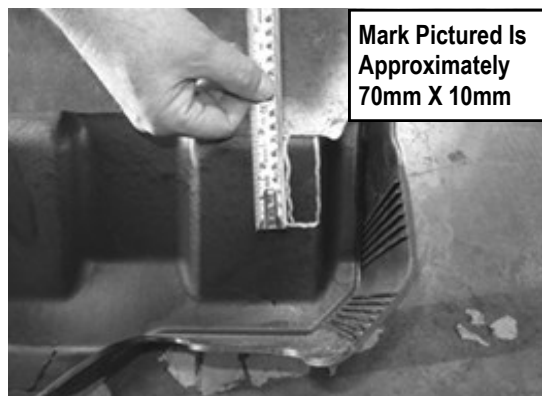

(Fig 15) 2017-Up Passenger Side DEF Cover Marked For Trimming

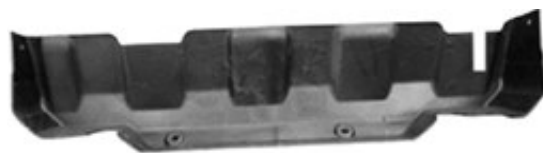

(Fig 16) 17-Up Passenger Side DEF Cut For Example Only

## STEP 10

Once the Step Bars are installed and all hardware fully tightened, reinstall the DEF tank and cover, if equipped, which was removed in **Step 8**. **The installation is completed.**

## STEP 11

Once all (2) Passenger side mounting brackets are installed, repeat **Step 6** to install the passenger side Step Bar.

### Attention

Do periodic inspections to the installation to make sure that all hardware is secure and tight.

In order to protect your bars/boards, please use mild soap/non-abrasive products for cleaning only.