

# iArmor®

## IARMOR EDGE™

PART#: IA-N095

### BEFORE INSTALLATION

REMOVE CONTENTS FROM BOX. VERIFY ALL PARTS ARE PRESENT. READ INSTRUCTIONS CAREFULLY BEFORE STARTING INSTALLATION. ASSISTANCE IS RECOMMENDED. THANK YOU FOR CHOOSING OUR PRODUCT!

\*DRILLING NOT REQUIRED

\*TRIMMING NOT REQUIRED

### Torque Value

Fastener Size	Tightening Torque (ft-lbs)
6mm	6-7
8mm	16-18
10mm	31-32
12mm	56-58
14mm	92-94

### PART LIST

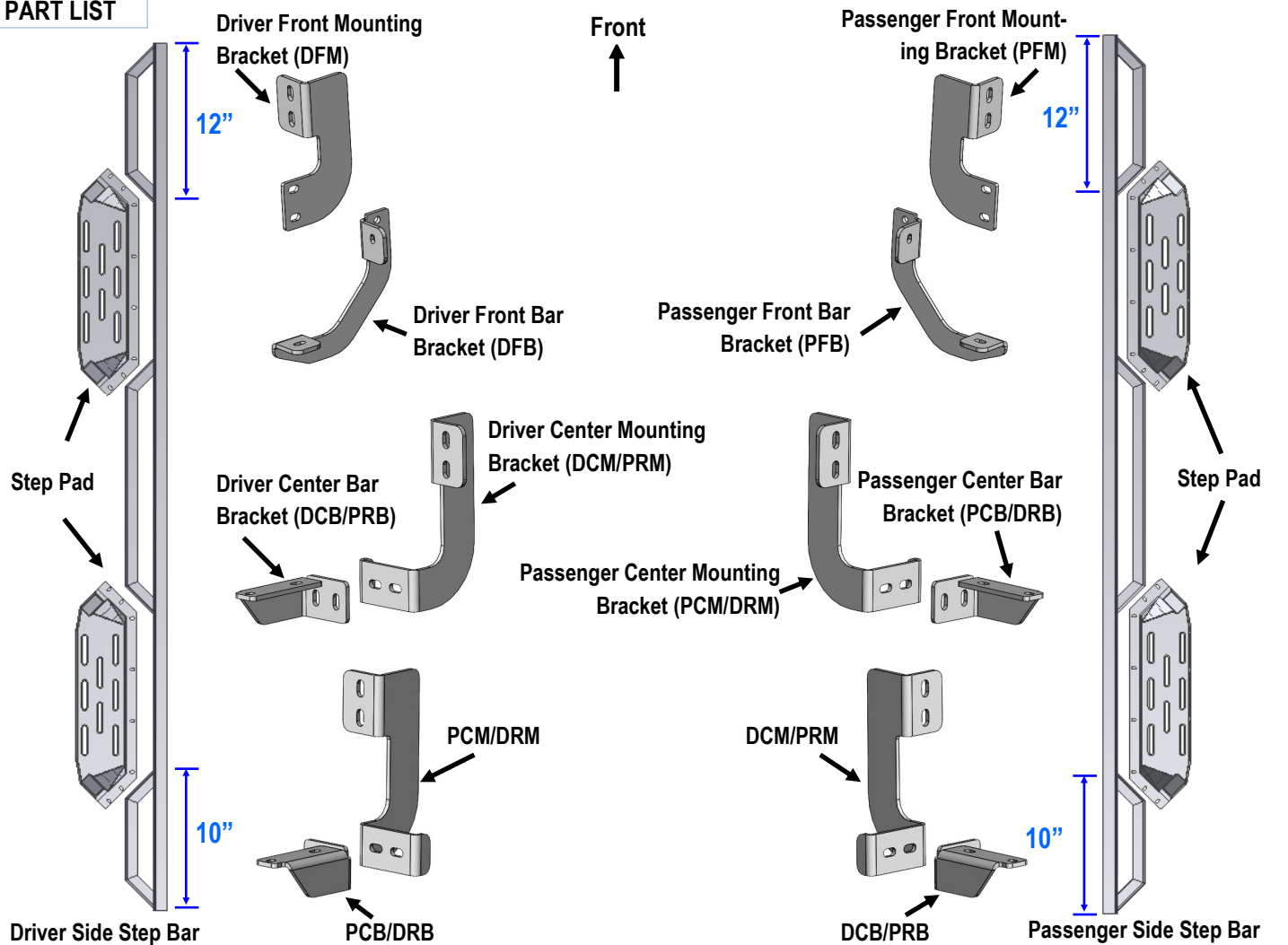

Customer Support: [info@iarmorauto.com](mailto:info@iarmorauto.com)

# iArmor®



**X24**

M8X1.25 Hex  
Flange Nut



**X12**

M8X1.25-20 Inner  
Hex Bolt



**X40**

M6X1-20 T-  
Bolt



**X4**

M6X1-20 Square  
Head Bolt



**X44**

M6 Large Flat  
Washer



**X44**

M6X1 Nylon  
Lock Nut



**X8**

M6X1-20 Flat  
Sunk Head Bolt

The instruction here is for your reference only. We strongly recommend the professional installer for best result. We are not responsible for any damage caused by the installation.

## STEP 1

Install the Step Pads onto the step bars with (32) M6x1-20mm T-Bolts, (32) M6 Large Flat Washers, (32) M6X1Nylon Lock Nuts and (8) M6X1-20mm Flat Sunk Head Bolts.

**IMPORTANT:** Don't hit the step pad by any metal hammer within step pad installation, or the step pad will be damaged.

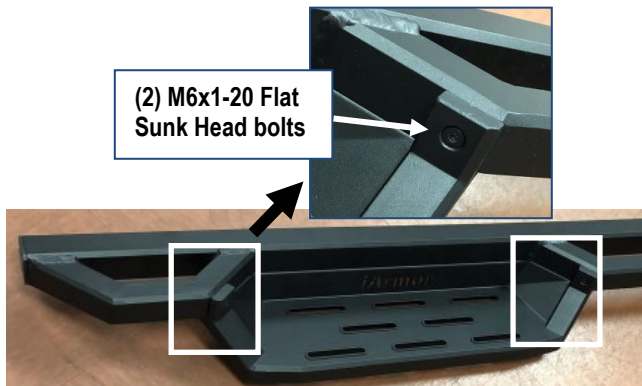

(2) M6x1-20 Flat  
Sunk Head bolts

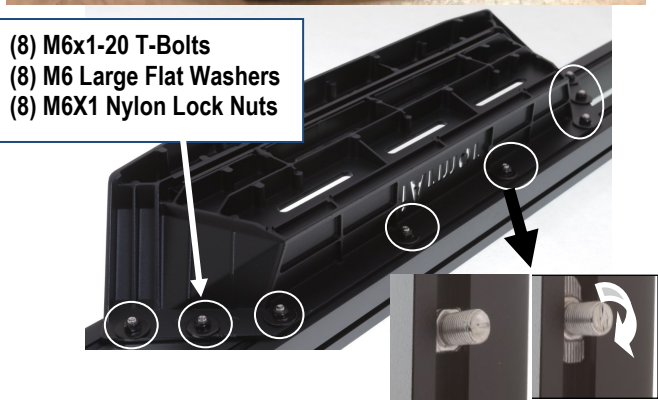

(8) M6x1-20 T-Bolts  
(8) M6 Large Flat Washers  
(8) M6X1 Nylon Lock Nuts

## STEP 2

Start the installation under the driver side of the vehicle, **(Fig 1)**.

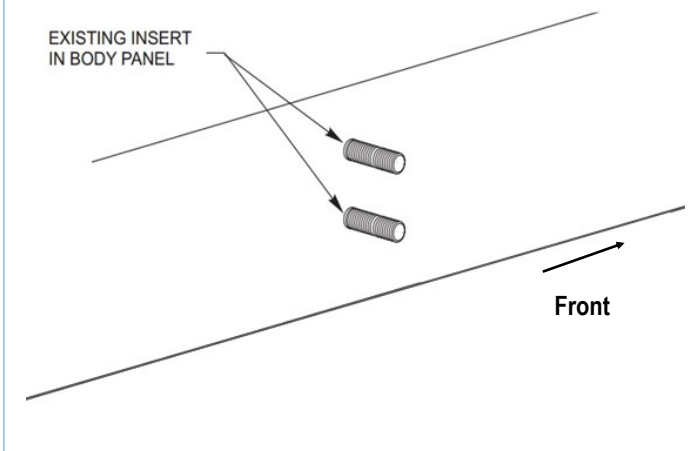

**(Fig 1) Driver Front Mounting Bracket Location Pictured**

## STEP 3

Select (1) Driver Front Mounting Bracket (**DFM**) and (1) Driver Front Bar Bracket (**DFB**). Attach the Bar Bracket to the Mounting Bracket with (2) M8X1.25 Hex Flange Nuts and (2) M8X1.25-20 Inner Hex Bolts, **(Fig 2)**. Do not fully tighten hardware at this time.

# iArmor®

## STEP 5

Repeat **STEPS 2-4** for Driver Side Center & Rear Brackets assembly and installation, (**Figs 4-5**). Do not fully tighten hardware at this time.

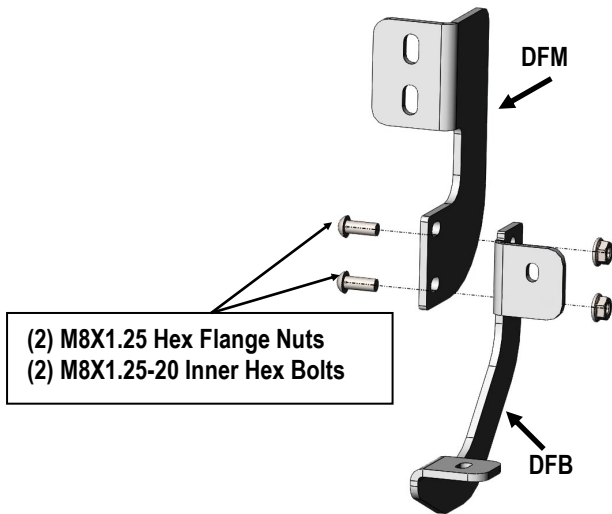

(Fig 2) Driver Side Front Brackets Assembly

## STEP 4

Next, attach the Assembled Driver Front Mounting Bracket (**DFM**) to the (2) factory studs with (2) M8X1.25 Hex Flange Nuts (**Fig 3**). Do not fully tighten hardware at this time.

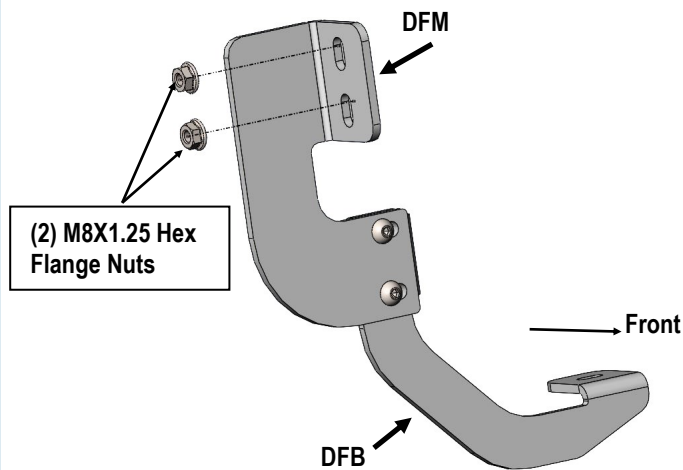

(Fig 3) Driver Center Mounting Bracket Installation

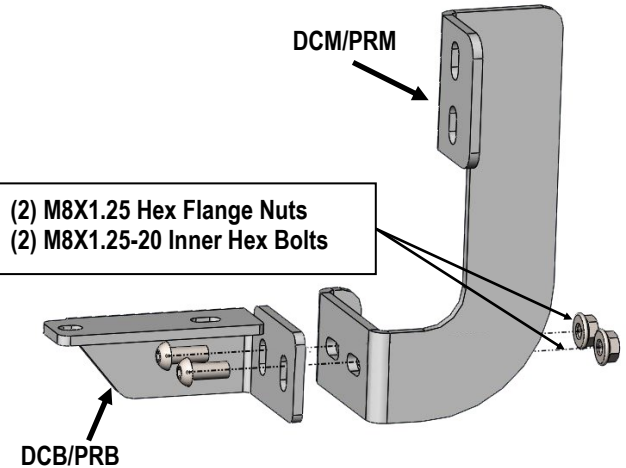

(Fig 4) Driver Side Center Brackets Assembly

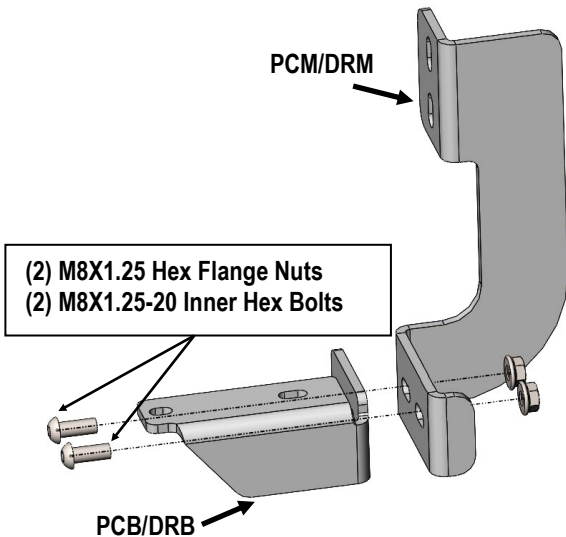

(Fig 5) Driver Side Rear Brackets Assembly

# iArmor®

## STEP 6

Once all (3) driver side mounting brackets are installed, attach the Assembled Driver Side Step Bar onto the brackets with (4) M6X1-20 T-Bolts, (2) M6X1-20 Square Head Bolts, (6) M6 Large Flat Washers and (6) M6x1 Nylon Lock Nuts, (**Fig 6**). Do not fully tighten hardware at this time.

## STEP 7

Properly level and adjust the Step Bar and fully tighten all hardware.

## STEP 8

Move to the passenger side of the vehicle. Repeat **Steps 2-7** to install passenger side step bar.

### Attention

Do periodic inspections to the installation to make sure that all hardware is secure and tight.

In order to protect your bars/boards, please use only mild soap/non-abrasive products for cleaning.

