

iArmor®

IARMOR EDGE™

PART#: IA-N176H

BEFORE INSTALLATION

REMOVE CONTENTS FROM BOX. VERIFY ALL PARTS ARE PRESENT. READ INSTRUCTIONS CAREFULLY BEFORE STARTING INSTALLATION. ASSISTANCE IS RECOMMENDED. THANK YOU FOR CHOOSING OUR PRODUCT!

*ROCKER PANEL MOUNT

*DRILLING NOT REQUIRED

Torque Value

Fastener Size	Tightening Torque (ft-lbs)	Required
6mm	6-7	√
8mm	16-18	√
10mm	31-32	X
12mm	56-58	X
14mm	92-94	X

PART LIST

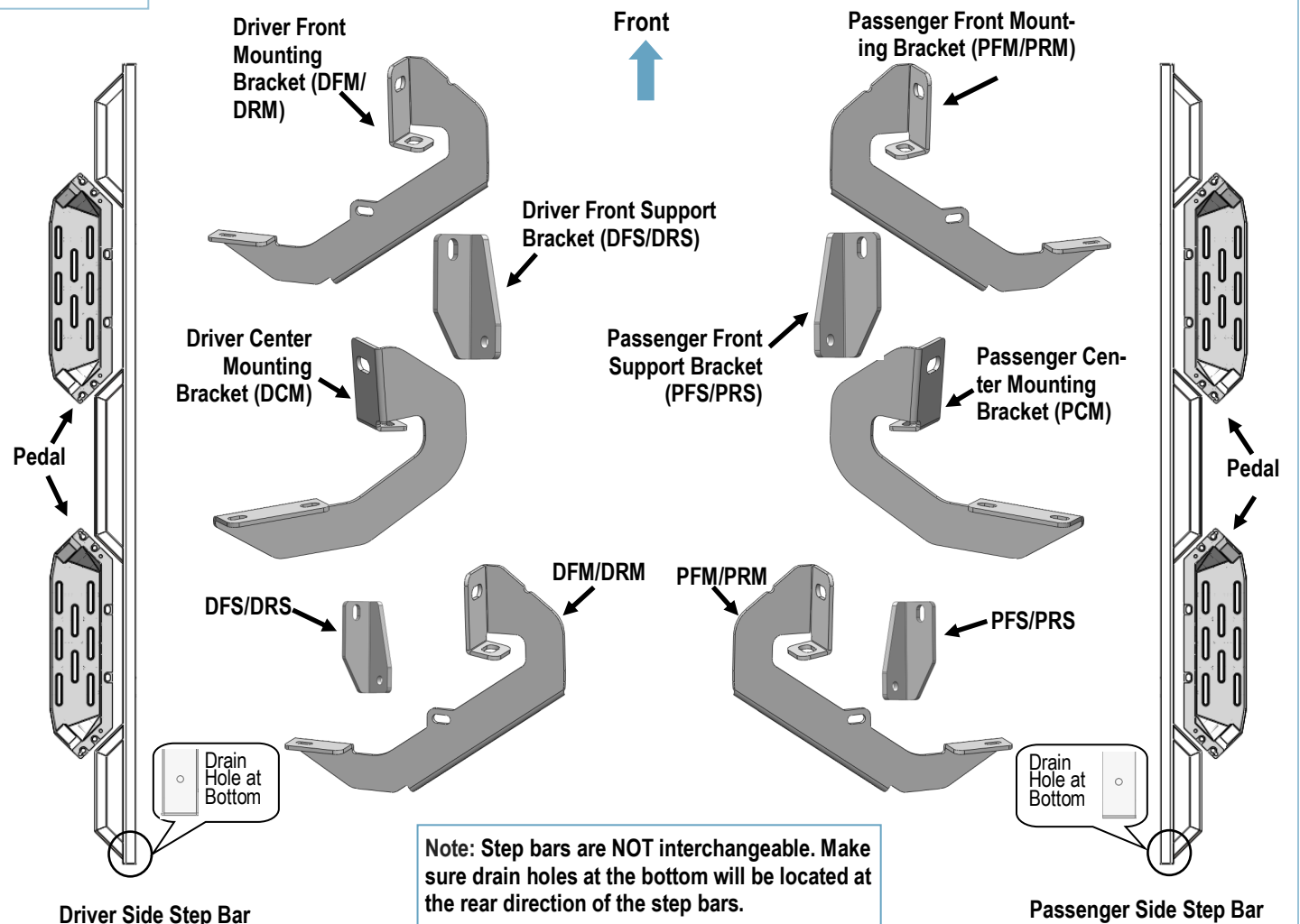

Customer Support: info@iarmorauto.com

iArmor®

Hardware Package A (For Brackets & Bars Installation)					
Item	QTY	Description	Item	QTY	Description
1#	10	M8X1.25-30mm Hex Bolts	8#	6	M8 Clip Nuts
2#	6	M8X1.25-25mm Hex Bolts	9#	4	M6X1-20 Square Head Bolts
3#	28	M8 Flat Washers	10#	4	M6 Large Flat Washers
4#	6	M8 Large Flat Washers	11#	4	M6 Nylon Lock Nuts
5#	12	M8 Lock Washers	12#	8	M8X1.25-20 T-Bolts
6#	6	M8 Hex Nuts	13#	8	M8 Plastic Washers
7#	12	M8 Nylon Lock Nuts			

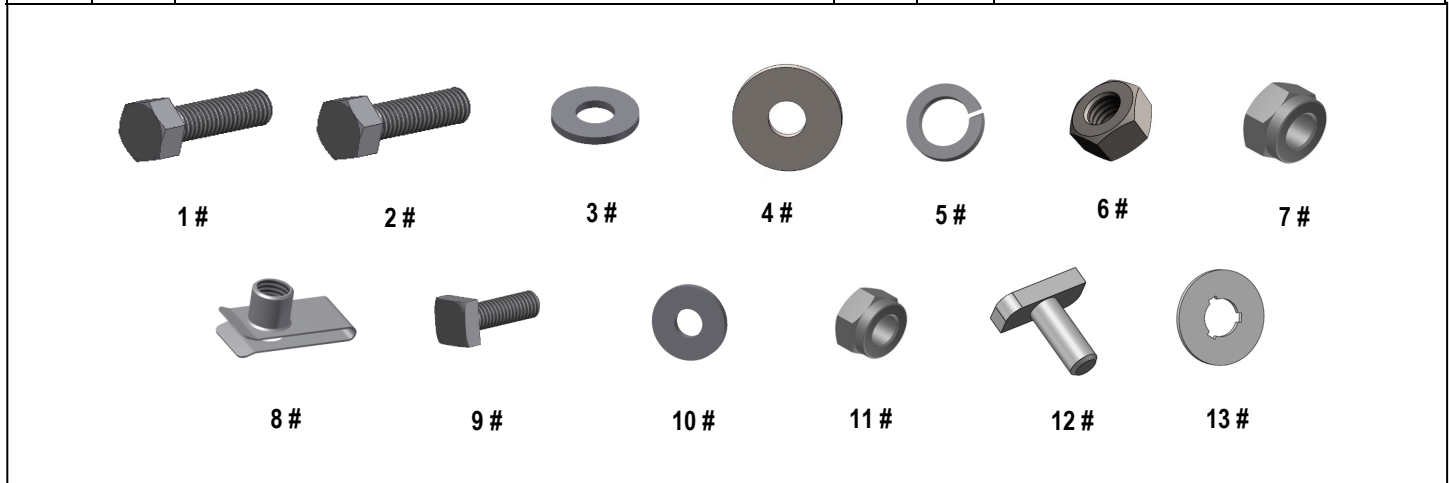

Hardware Package B (For Step Pedals Installation)					
Item	QTY	Description	Item	QTY	Description
1#	24	M8X1.25-25 Hex Bolts	3#	24	M8 Lock Washers
2#	24	M8 Flat Washers			

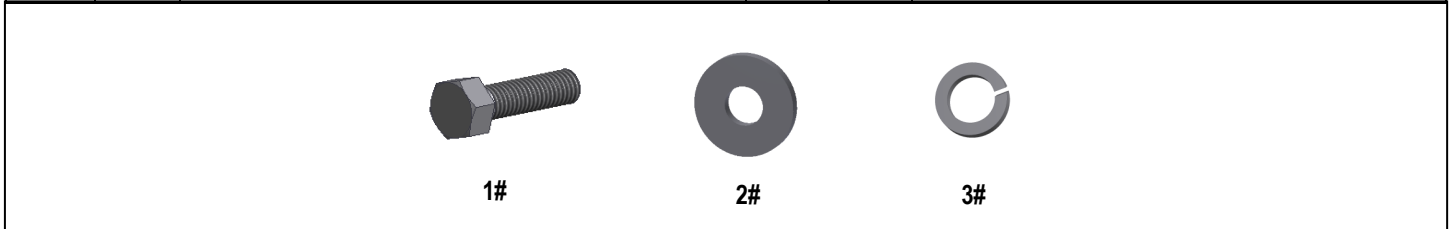

Customer Support: info@iarmorauto.com

iArmor®

The instruction here is for your reference only. We strongly recommend the professional installer for best result. We are not responsible for any damage caused by the installation.

STEP 1

Install (4) Pedals onto the step bars with (24) M8X1.25-25mm Hex Bolts, (24) M8 Flat Washers and (24) M8 Lock Washers.

IMPORTANT: Don't punch the pedal with any metal hammer within pedal installation, or the pedal will be damaged.

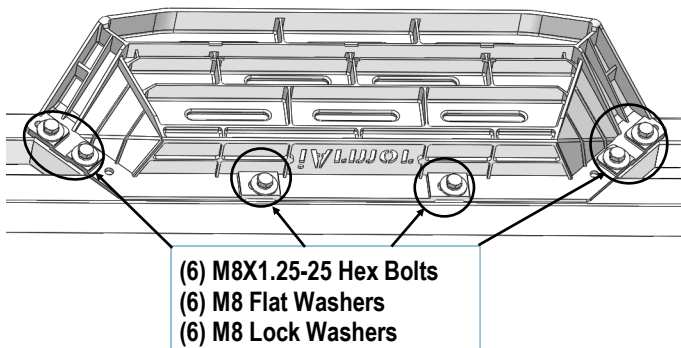

STEP 2

Starting on the driver side of the vehicle, locate the (2) holes on the pinch weld, (Fig 1). Then locate the rectangular opening with (2) small holes on the inner side of body panel directly above the (2) holes on the pinch weld, (Fig 1 & 2).

NOTE: The holes on the inner side of body panel may be covered with sealing tapes or insulations, remove if equipped.

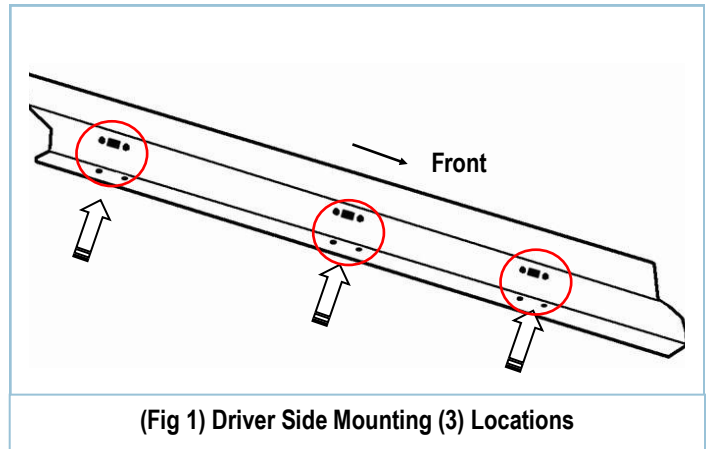

STEP 3

Slide (1) M8 Clip Nut into the rectangular opening with the nut towards the inside. Line up the threaded nut on the clip with the round hole, (Fig 2).

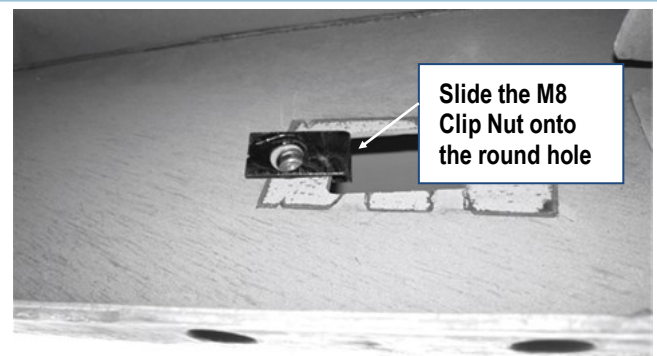

(Fig 2) M8 Clip Nuts Installed

STEP 4

Assemble the Driver Front Mounting Bracket (DFM/DRM) and Driver Front Support Bracket (DFS/DRS) with (1) M8X1.25-30 Hex Bolt, (2) M8 Flat Washers and (1) M8X1.25 Nylon Lock Nut, (Fig 3). Do not fully tighten hardware at this time.

iArmor®

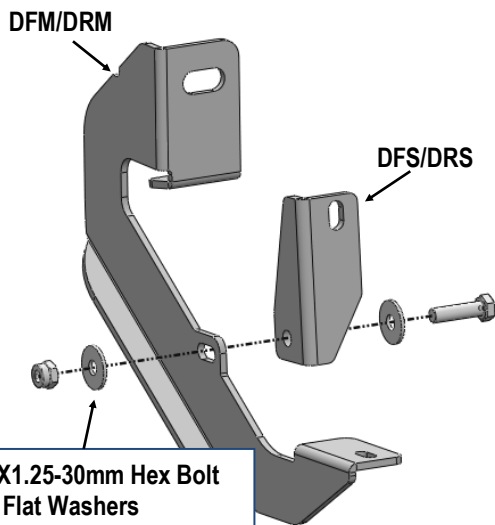

- (1) M8X1.25-30mm Hex Bolt
- (2) M8 Flat Washers
- (1) M8 Nylon Lock Nut

(Fig 3) Driver Front Brackets Assembly

STEP 5

Attach the Assembled Driver Front Mounting Bracket to the (1) installed M8 Clip Nut on the body panel with the included (1) M8X1.25-30mm Hex Bolt, (1) M8 Lock Washer and (1) M8 Large Flat Washer, (Fig 4). Do not fully tighten hardware at this time.

NOTE: Depending on the model/year of the vehicle, the brake cable may be run on the inside or outside of the Bracket.

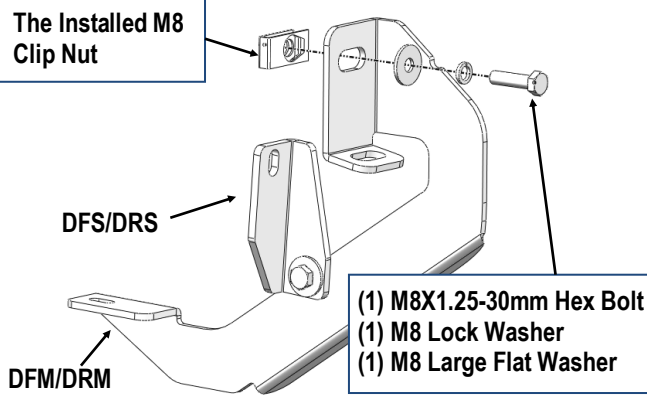

(Fig 4) Driver Front Mounting Bracket Installation

STEP 6

Align the lower hole on the Front Mounting Bracket with the (1) hole on the pinch weld. Secure the Assembled Driver Front Mounting Bracket to the pinch weld with (1) M8X1.25-25mm Hex Bolt, (2) M8 Flat Washers, (1) M8 Lock Washer and (1) M8X1.25 Hex Nut, (Fig 5). Do not fully tighten hardware at this time.

NOTE: Insert the bolt up from the bottom of the pinch weld and through the Bracket.

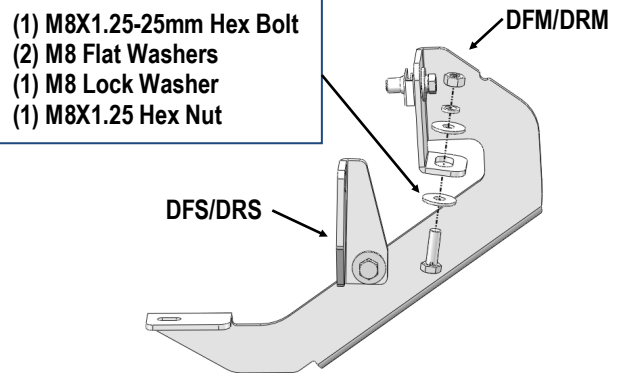

(Fig 5) Driver Front Mounting Bracket Installation
(Secure to the Pinch Weld)

STEP 7

Move to the Driver Side Center Mounting location, (Fig 1). Repeat Steps 5 & 6 to install the Driver Center Mounting Bracket (DCM), (Fig 6). Do not tighten hardware at this time.

STEP 8

Move to the Driver Side Rear Mounting Location. Repeat Steps 3-6 to install the Driver Side Rear Brackets. Do not fully tighten hardware at this time.

iArmor[®]

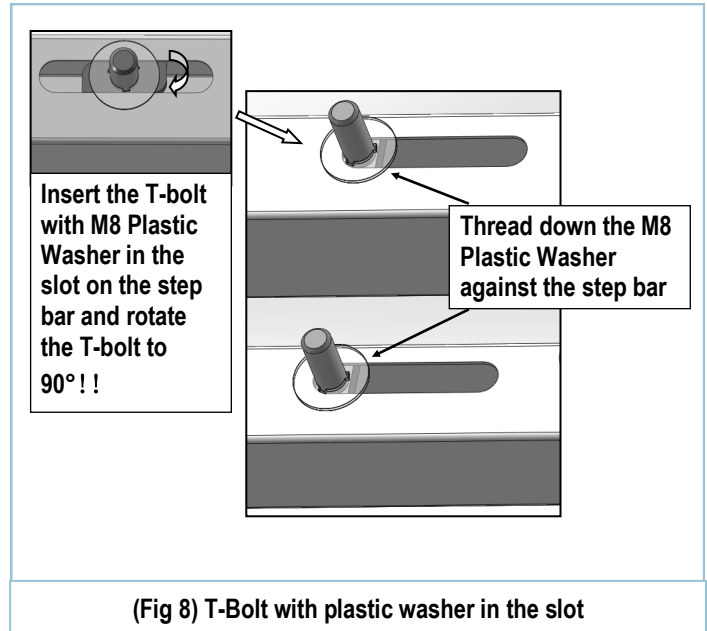
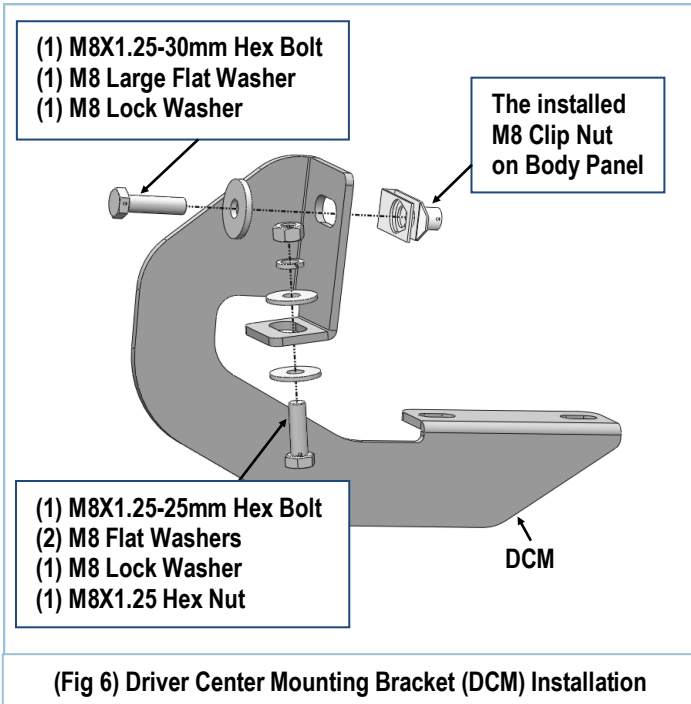

STEP 9

Once all (3) brackets have been installed, select (4) M8X1.25-20mm T-Bolts, thread (1) M8 Plastic Washer on each T-Bolt, (Fig 7). Install the (4) M8X1.25-20mm T-Bolts with plastic washers in the slots on the assembled step bar. Rotate the T-Bolts to 90 degree, thread down the M8 Plastic Washers against the step bar (Fig 8).

NOTE: The Plastic Washer is designed to keep the T-Bolt in place to avoid falling into the tube during installation.

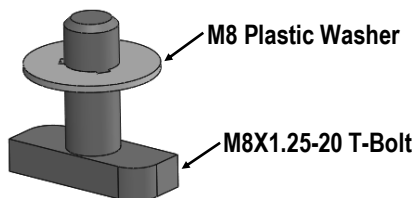

(Fig 7) Thread (1) M8 Plastic Washer on each T-Bolt Before Inserting into the slot !!!

STEP 10

Attach the Assembled Driver Side Step Bar onto the Mounting Brackets with (4) M8 Plastic Washers, (4) M8X1.25-20mm T-Bolts, (4) M8 Flat Washers, (4) M8 Nylon Lock Nuts, (Fig 9). Do not fully tighten hardware at this time.

NOTE: the Driver Front & Rear Mounting Brackets are located under the front & rear pedals. Slide (2) M6X1-20mm Square Head Bolts into the channel at the bottom of pedals (Fig 10). And secure the Front & Rear Mounting Brackets to the pedals with (2) M6 Large Flat Washers and (2) M6 Nylon Lock Nuts, (Fig 9). Do not fully tighten hardware at this time.

STEP 11

Level and adjust the assembled Step Bar properly and tighten all hardware.

Move to the other side of the vehicle. Repeat **Steps 2-10** for the other Side Step Bar installation.

iArmor®

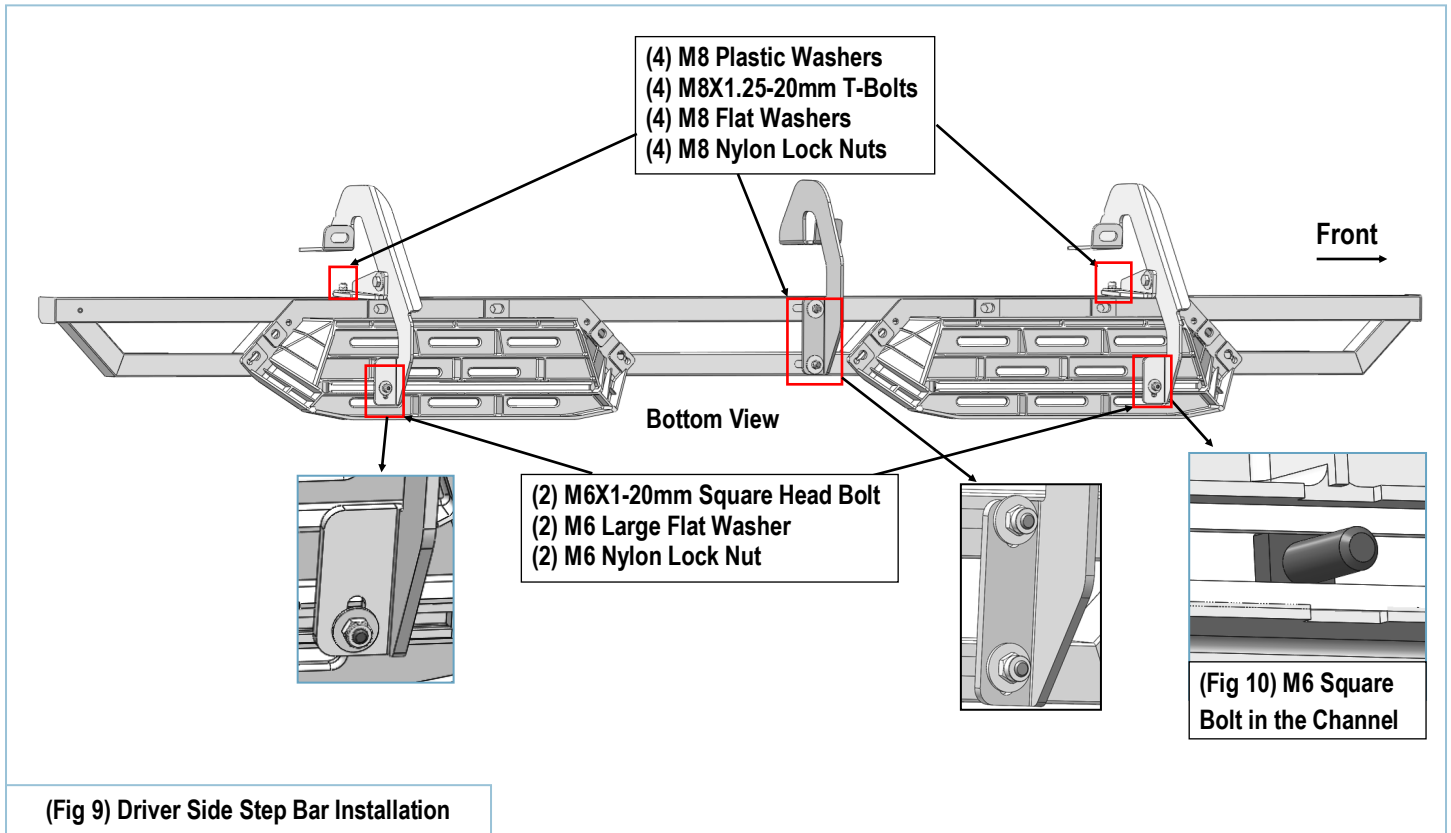

Attention

Do periodic inspections to the installation to make sure that all hardware is secure and tight.
In order to protect your bars/boards, please use mild soap/non-abrasive products for cleaning only.