

# iArmor<sup>®</sup>

## iArmor<sup>®</sup> by APS

PART#: IA-S912H

### BEFORE INSTALLATION

REMOVE CONTENTS FROM BOX. VERIFY ALL PARTS ARE PRESENT. READ INSTRUCTIONS CAREFULLY BEFORE STARTING INSTALLATION. ASSISTANCE IS RECOMMENDED. THANK YOU FOR CHOOSING OUR PRODUCT!

\*ROCKER PANEL MOUNT

\*DRILLING NOT REQUIRED

### Torque Value

Fastener Size	Tightening Torque (ft-lbs)	Required
6mm	6-7	X
8mm	16-18	√
10mm	31-32	√
12mm	56-58	X
14mm	92-94	X

### PART LIST

#### Driver Side Step Bar

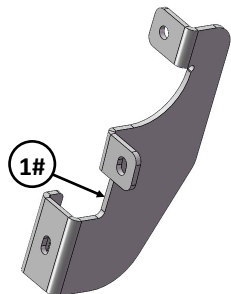
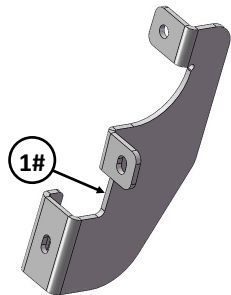
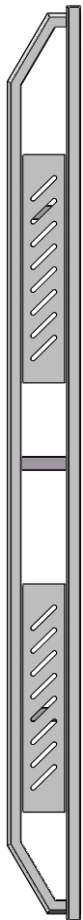

#### Front



#### Passenger Side Step Bar

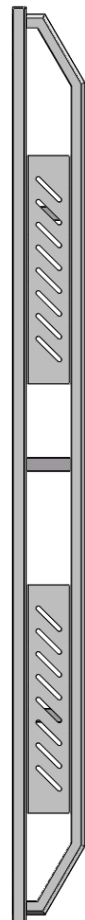
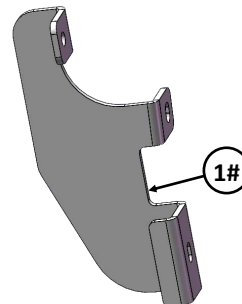
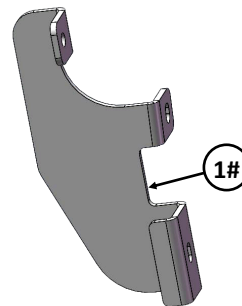

Customer Support: [info@iarmorauto.com](mailto:info@iarmorauto.com)

# iArmor<sup>®</sup>

## Hardware Package A (For Bracket Installation)

Item	QTY	Description	Item	QTY	Description
1#	4	Mounting Brackets	5#	8	M10 Flat Washers
2#	4	U Brackets	6#	8	M10 Lock Washers
3#	4	M10X35mm Bolt Plates	7#	4	M10X1.5 Hex Nuts
4#	4	M10X1.5-25mm Hex Bolts	8#	4	M10X1.5-19.5mm Rivet Nuts

## Hardware Package B (For Step Bar Installation)

Item	QTY	Description	Item	QTY	Description
1#	4	M8X1.25-55mm Carriage Bolts	3#	4	M8 Lock Washers
2#	4	M8 Large Flat Washers	4#	4	M8 Hex Nuts

# iArmor®

The instruction here is for your reference only. We strongly recommend the professional installer for best result. We are not responsible for any damage caused by the installation.

## STEP 1

Start from the driver side. Separate trim from rocker panel and insert M10x35mm Bolt Plate as shown, (Figs 1 & 2). Do not fully tighten hardware at this time. Insert M10X1.5-19.5mm Rivet Nuts as shown, (Fig 2).

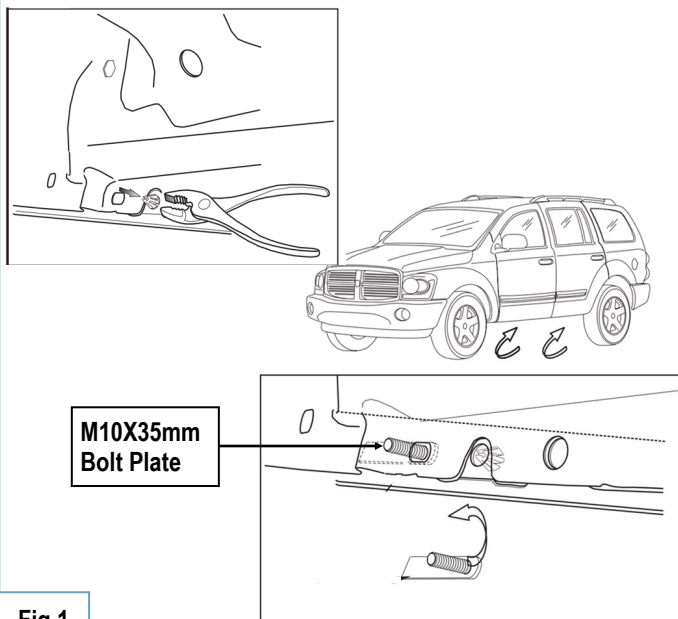

Fig 1

M10X1.5-19.5mm Rivet Nuts

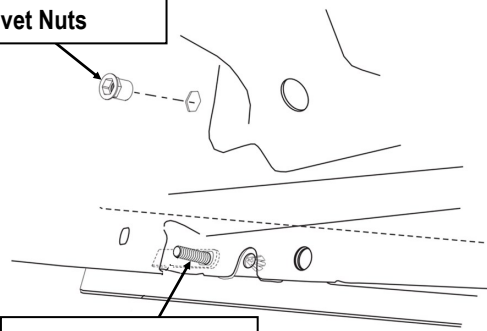
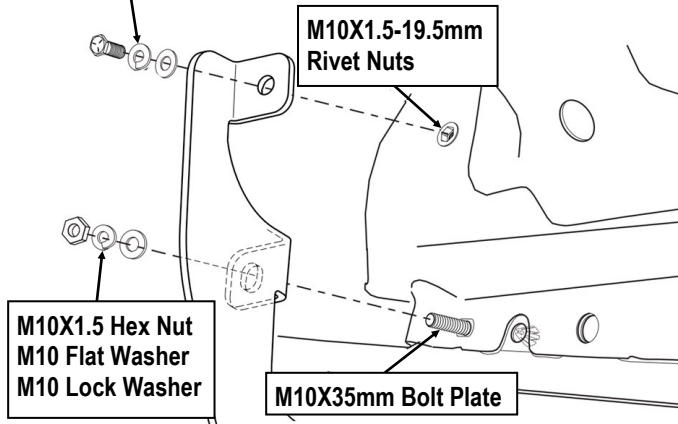

Fig 2

## STEP 2

Attach (1) Mounting Bracket with (1) M10X1.5-25mm Hex Bolt, (2) M10 Flat Washers, (2) M10 Lock Washers and (1) M10X1.5 Hex Nut, (Fig 3). Do not fully tighten hardware at this time.

M10X1.5-25mm Hex Bolt  
M10 Flat Washer  
M10 Lock Washer



(Fig 3) Driver Front Mounting Bracket Installation

## STEP 3

Tighten top bolt to crimp Rivet Nut until increased resistance is felt. Verify M10X1.5-19.5mm Rivet Nut is not loose in hole, otherwise re-tighten. Hole M10x35mm Bolt Plate parallel to rocker panel and tighten bottom nut. Re-attach trim panel as shown, (Fig 4).

Repeat **Steps 1-3** for driver side rear bracket installation.

# iArmor®

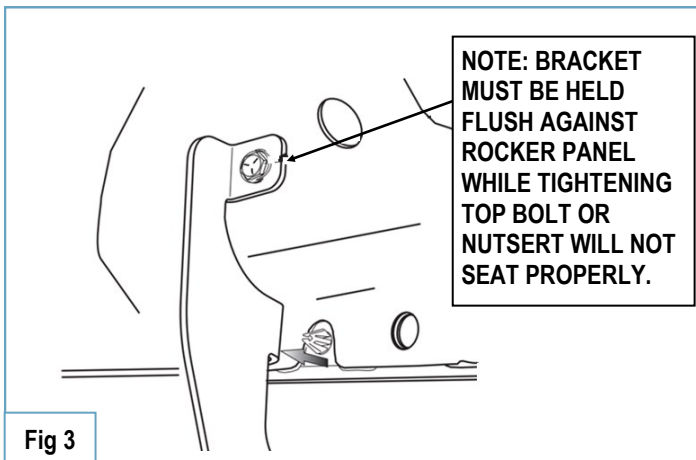

## STEP 5

Properly level and adjust the Step Bar and fully tighten all hardware.

## STEP 6

Move to the passenger side of the vehicle. Repeat **Steps 1-5** to install passenger side step bar.

Installation completed.

## STEP 4

Once all (2) driver side mounting brackets are installed, select and attach the Driver Side Step Bar onto the Mounting Brackets with (2) U Brackets, (2) M8X1.25-55mm Carriage Bolts, (2) M8 Large Flat Washers, (2) M8 Lock Washers and (2) M8X1.25 Hex Nuts, (Fig 5). Do not fully tighten hardware at this time.

### Attention

Do periodic inspections to the installation to make sure that all hardware is secure and tight.

In order to protect your bars/boards, please use mild soap/non-abrasive products for cleaning only.

