

## IARMOR EDGE™

PART#: IA-N913H

### BEFORE INSTALLATION

REMOVE CONTENTS FROM BOX. VERIFY ALL PARTS ARE PRESENT. READ INSTRUCTIONS CAREFULLY BEFORE STARTING INSTALLATION. ASSISTANCE IS RECOMMENDED. THANK YOU FOR CHOOSING OUR PRODUCT!

\*ROCKER PANEL MOUNT

\*DRILLING NOT REQUIRED

### Torque Value

Fastener Size	Tightening Torque (ft-lbs)	Required
6mm	6-7	√
8mm	16-18	√
10mm	31-32	√
12mm	56-58	X
14mm	92-94	X

### PART LIST

#### Driver Side Step Bar

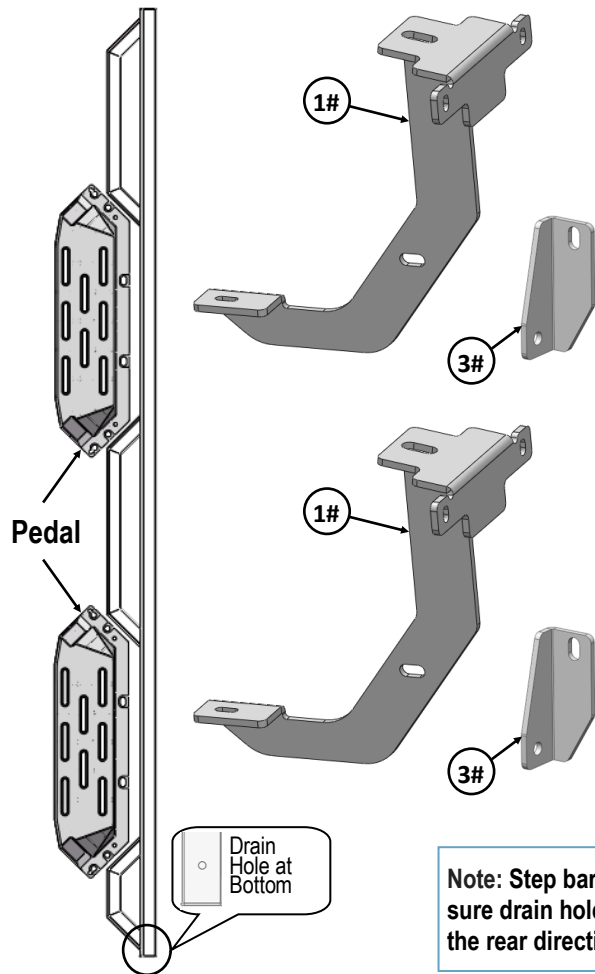

Front



#### Passenger Side Step Bar

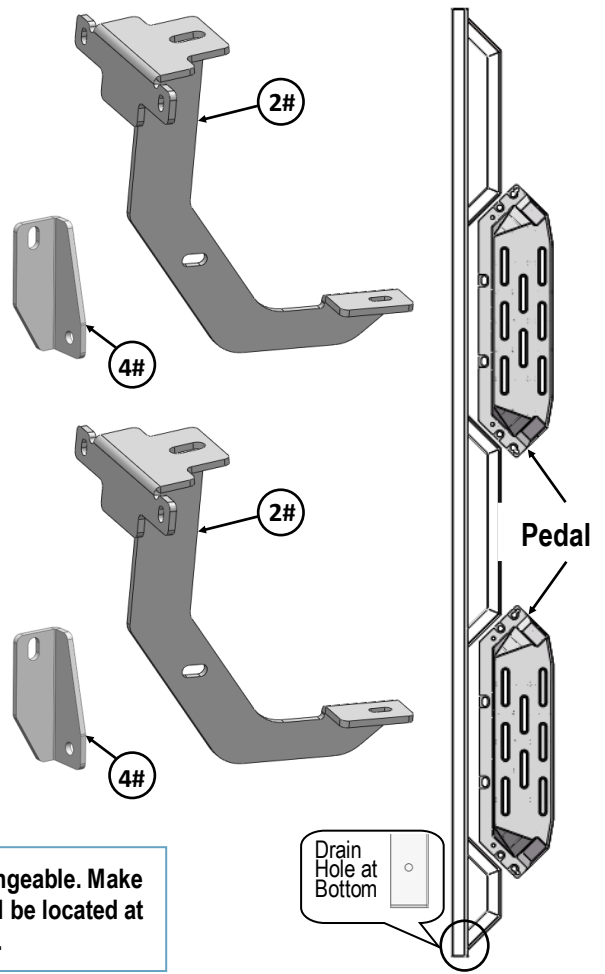

**Note: Step bars are NOT interchangeable. Make sure drain holes at the bottom will be located at the rear direction of the step bars.**

# iArmor®

Hardware Package A (For Brackets & Bars Installation)					
Item	QTY	Description	Item	QTY	Description
1#	2	Driver Front / Rear Mounting Brackets	10#	12	M6 Large Flat Washers
2#	2	Passenger Front / Rear Mounting Brackets	11#	8	M6 Flat Washers
3#	2	Driver Front / Rear Support Brackets	12#	12	M6 Nylon Lock Nuts
4#	2	Passenger Front / Rear Support Brackets	13#	4	M8X1.25-30 Hex Bolts
5#	4	M10 Bolt Plates	14#	12	M8 Large Flat Washers
6#	4	M10 Plastic Washers	15#	8	M8 Nylon Lock Nuts
7#	4	M10 Large Flat Washers	16#	4	M6 Square Head Bolts
8#	4	M10 Hex Flange Nuts	17#	4	M8X1.25-20 T Bolts
9#	8	M6X1-25 Hex Bolts	18#	4	M8 Plastic Washers

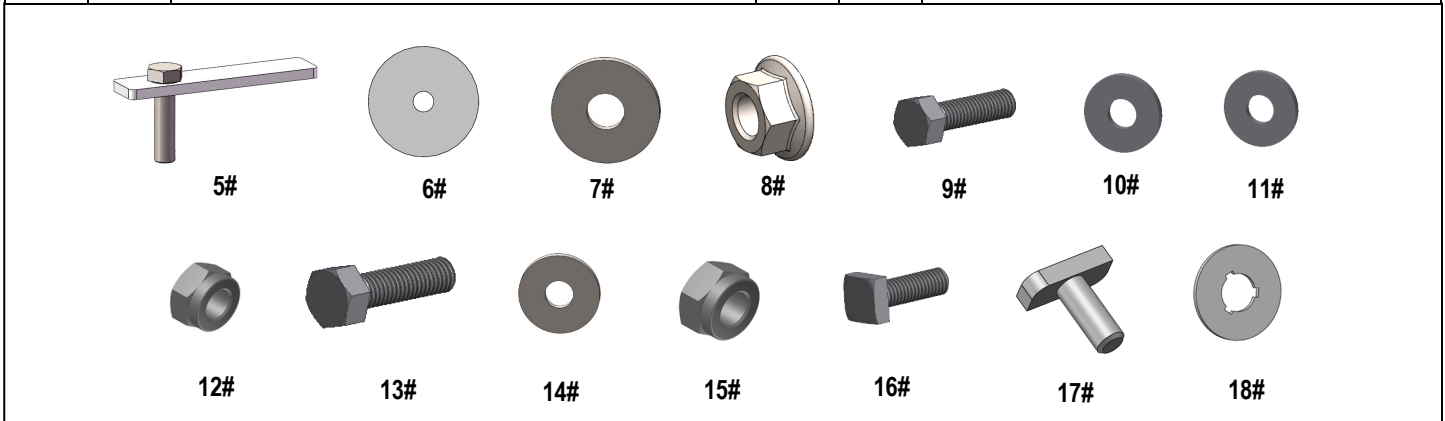

Hardware Package B (For Step Pedals Installation)					
Item	QTY	Description	Item	QTY	Description
1#	24	M8X1.25-25 Hex Bolts	3#	24	M8 Lock Washers
2#	24	M8 Large Flat Washers			

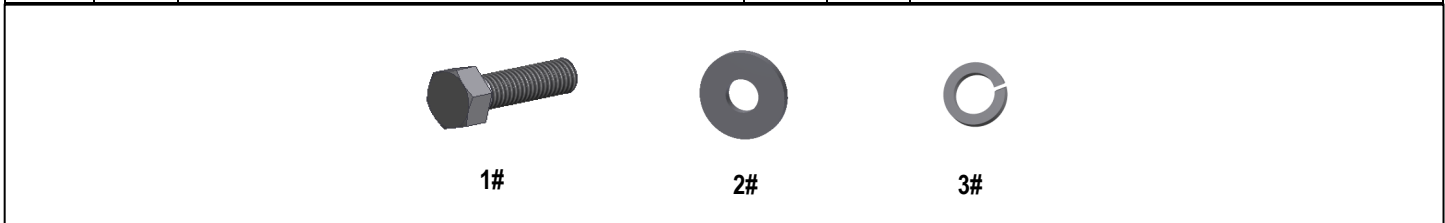

Customer Support: [info@iarmorauto.com](mailto:info@iarmorauto.com)

# iArmor<sup>®</sup>

The instruction here is for your reference only. We strongly recommend the professional installer for best result. We are not responsible for any damage caused by the installation.

## STEP 1

Install (4) Pedals onto the step bars with (24) M8X1.25-25mm Hex Bolts, (24) M8 Large Flat Washers and (24) M8 Lock Washers.

**IMPORTANT:** Don't punch the pedal with any metal hammer within pedal installation, or the pedal will be damaged.

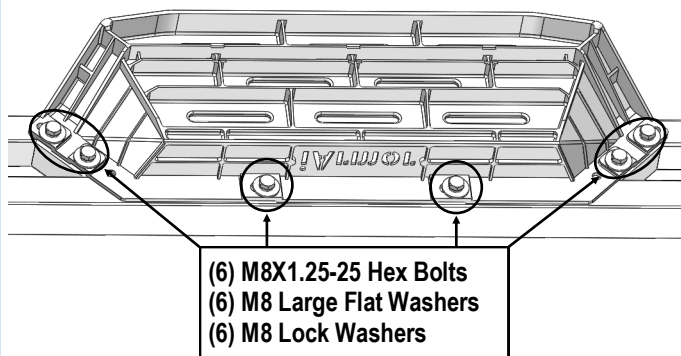

## STEP 2

Start installation from the driver side of the vehicle, locate the (2) pairs of factory holes on the pinch weld, (Figs 1 & 2).

Under the Driver Side Front Mounting location, remove the rubber plugs covering the oval hole at the bottom of the rocker panel, if equipped, (Fig 3).

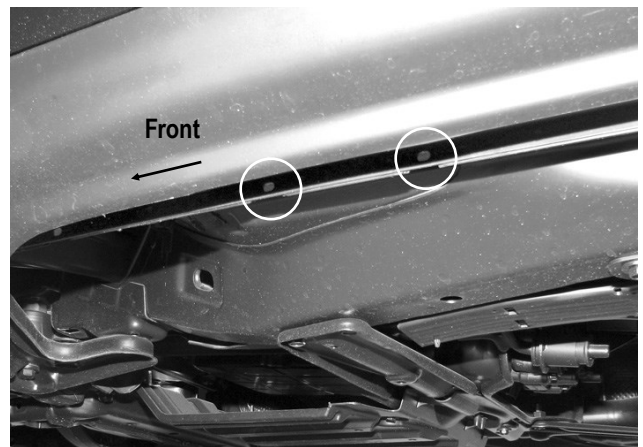

(Fig 1) Drive Front Mounting Bracket Location

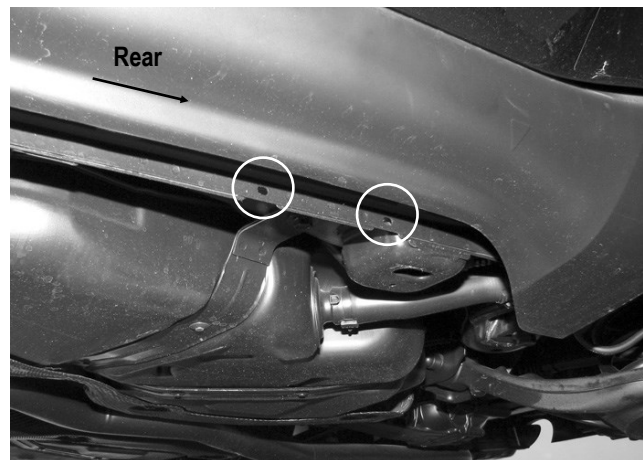

(Fig 2) Driver Rear Mounting Bracket Location

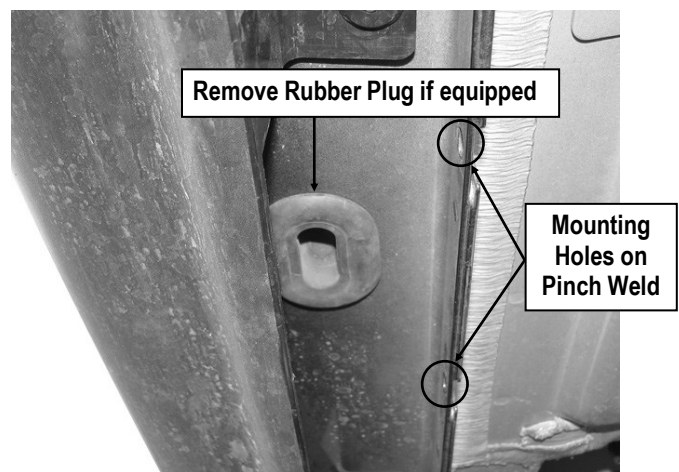

(Fig 3) Driver Side Front Mounting Location

## STEP 3

Select (1) M10 Bolt Plate and (1) M10 Plastic Washer. Partially thread the M10 Plastic Washer onto the Welded Bolt. Insert the M10 Bolt Plate into the oval hole and rotate across the slot, **(Fig 4)**. Thread the M10 Plastic Washer all the way down the Welded Bolt and tight against the body panel.

**NOTE:** The M10 Plastic Washer is designed to prevent the Bolt Plate from falling into the body panel and hold the bolt plate in place within the bracket installation.

After inserting, rotate M10 Bolt Plate across the slot or until M10 Bolt Plate stopped.



**(Fig 4)** M10 Bolt Plate Installed on Driver Side Front Mounting Location

## STEP 4

Assemble (1) Driver Front Mounting Bracket and (1) Support Bracket with (1) M8X1.25-35mm Hex Bolt, (2) M8 Flat Washers, (1) M8 Lock Washer and (1) M8 Hex Nut, **(Fig 5)**. Do not fully tighten hardware at this time.

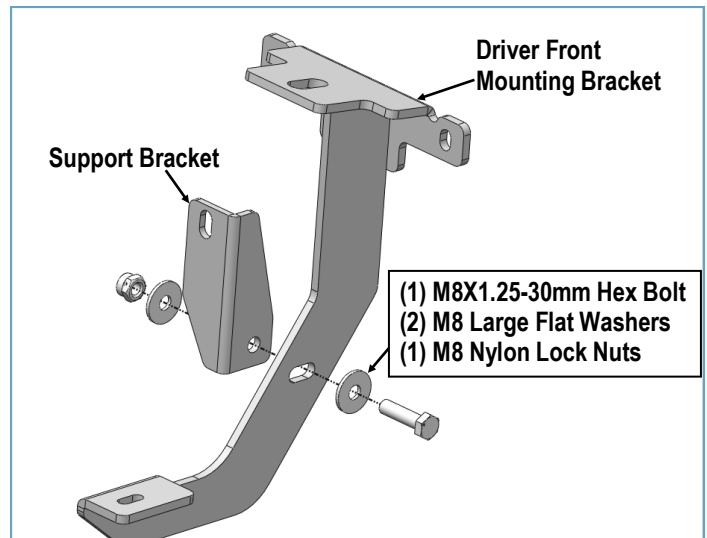

**(Fig 5)** Driver Side Front Mounting Bracket Assembly

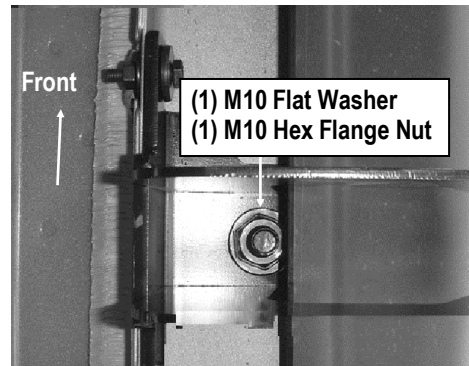

**(Fig 6)** Driver Front Mounting Bracket Installation

## STEP 5

Attach the Driver Front Mounting Bracket to the installed M10 Bolt Plate with (1) M10 Flat Washer and (1) M10 Hex Flange Nut, **(Figs 6-8)**.

Line up the (2) small slots on the Driver Front Mounting Bracket with the (2) holes on the pinch weld. Bolt the Driver Front Mounting Bracket to the outside of the pinch weld with (2) M6x1-25mm Hex Bolts, (2) M6 Large Flat Washers (outside against Bracket), (2) M6 Flat Washers (inside against pinch weld) and (2) M6 Nylon Lock Nuts, **(Figs 6 –8)**. Do not fully tighten hardware at this time.

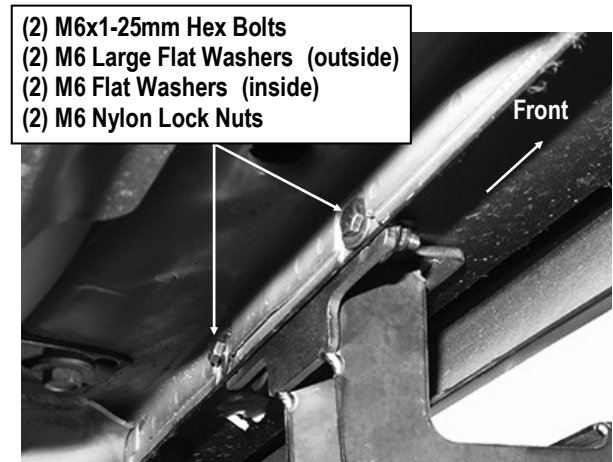

**(Fig 7)** Driver Front Mounting Bracket Installation

# iArmor®

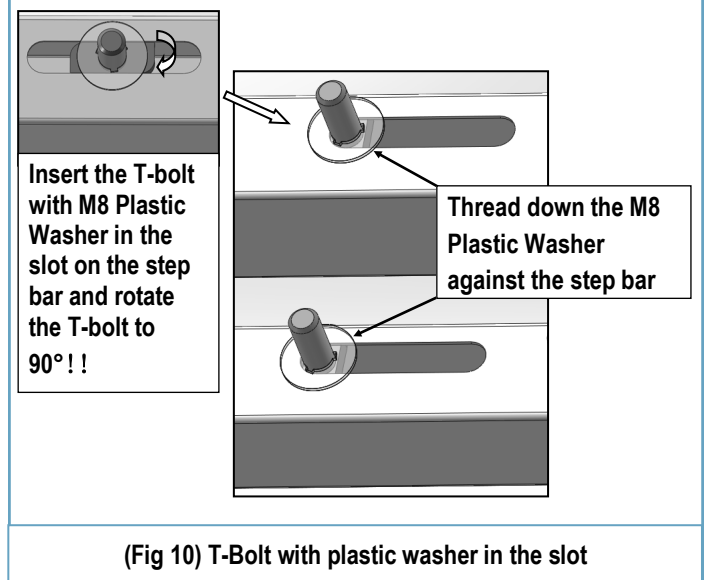
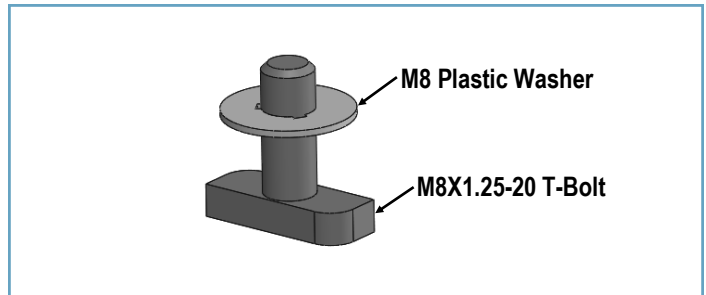
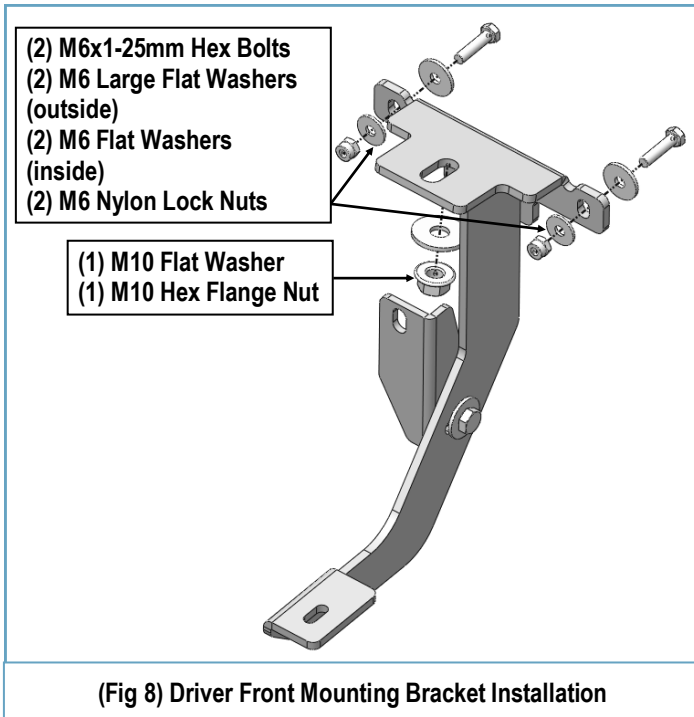

## STEP 6

Repeat **Steps 2-5** to install and assemble the Driver Rear Mounting Bracket and the Support Bracket. Do not fully tighten hardware at this time.

**Note:** Driver Front Mounting Bracket & Driver Rear Mounting Brackets are universal.

## STEP 7

Once all (2) brackets have been installed, select (2) M8X1.25-20mm T-Bolts, thread (1) M8 Plastic Washer on each T-Bolt, (**Fig 9**). Install the (2) M8X1.25-20mm T-Bolts with plastic washers in the slots on the assembled Driver side step bar. Rotate the T-Bolts to 90 degree, thread down the M8 Plastic Washers against the step bar (**Fig 10**).

**NOTE:** The Plastic Washer is designed to keep the T-Bolt in place to avoid falling into the tube during installation.

## STEP 8

Attach the Assembled Driver Side Step Bar onto the Mounting Brackets with (2) M8 Plastic Washers, (2) M8X1.25-20mm T-Bolts, (2) M8 Large Flat Washers, (2) M8 Nylon Lock Nuts, (**Fig 11**). Do not fully tighten hardware at this time.

**NOTE:** Driver Front & Rear Mounting Brackets are located under (2) pedals. Slide (2) M6X1-20mm Square Head Bolts into the channels at the bottom of pedals (**Fig 12**). And secure the Driver Front & Rear Mounting Brackets to pedals with (2) M6 Large Flat Washers and (2) M6 Nylon Lock Nuts, (**Fig 11**). Do not fully tighten hardware at this time.



# iArmor®

## STEP 9

Level and adjust the assembled Step Bar properly and tighten all hardware.

Move to the other side of the vehicle. Repeat **Steps 2-8** for the other side step bar installation.

### Attention

Do periodic inspections to the installation to make sure that all hardware is secure and tight.

In order to protect your bars/boards, please use mild soap/non-abrasive products for cleaning only.

(Fig 11) Driver Side Step Bar Installation

