



Hitch Installation Instruction

REV.20251001

Part#	HT-X30216	Application	For 1991-2001 Ford Explorer Excluding oversized spare tire\2001-2003 Ford Explorer Sport Excluding oversized spare tire\1991-1994 Mazda Navajo All\1997-2001 Mercury Mountaineer Except With Oversized Spare
-------	-----------	-------------	--

Hardware List	Item	Part Name	QTY	Description	Item	Part Name	QTY	Description
Hitch Parts	A	Hitch Body	1		B/C	Mounting Brackets	2	B-Driver Side C-Passenger Side
HW B (For Hitch Installation)	1#	Spacers	2	Square Hole	5#	Hex Flange Nuts	2	M12X1.75
	2#	Spacers	2	Round Hole	6#	Hex Bolts	2	M14X2-40
	3#	Hex Nuts	2	M14	7#	Carriage Bolts	2	M12X1.75-45
	4#	Lock Washers	2	M14				
HW A (For Hitch Assembly)	8#	Hex Bolts	6	M12X1.75-35	10#	Lock Washers	6	M12
	9#	Flat Washers	10	M12	11#	Hex Nuts	4	M12X1.75

Gross Load Capacity When Used As A Weight Carrying Hitch: 5000 LBS. Trailer Weight & 500 LBS. Tongue Weight.
Gross Load Capacity When Used As A Weight Distribution Hitch: 6000 LBS. Trailer Weight & 600 LBS. Tongue Weight.
*****DO NOT EXCEED VEHICLE MANUFACTURER'S RECOMMENDED TOWING CAPACITY.*****

- * No Trimming Required
- * Drilling Required

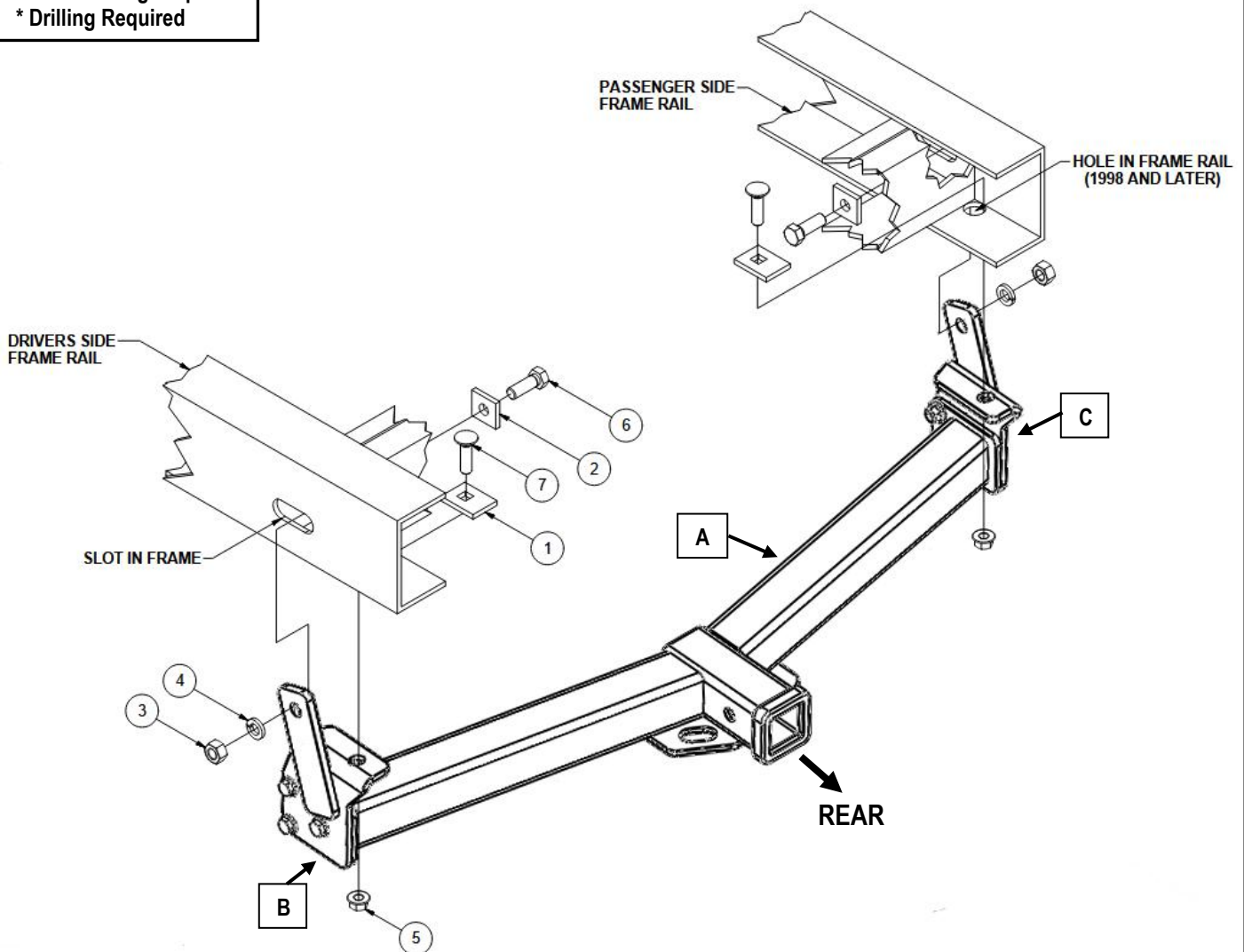

The instruction here is for your reference only. We strongly recommend the professional installer for best result.
We are not responsible for any damage caused by the installation. Thank you for choosing our product!



Hitch Installation Instruction

REV.20251001

Part#	HT-X30216	Application	For 1991-2001 Ford Explorer Excluding oversized spare tire\2001-2003 Ford Explorer Sport Excluding oversized spare tire\1991-1994 Mazda Navajo All\1997-2001 Mercury Mountaineer Except With Oversized Spare
Step	Description		
1	Assemble Hitch Body (A) and Mounting Brackets (B, C) with (6) M12X1.75-35mm Hex Bolts, (10) M12 Flat Washers, (6) M12 Lock Washers, (4) M12 Hex Flange Nuts.(Hardware in “HW A”). Note:Finger tighten only. Do not fully tighten at this time.		
2	Raise receiver into position under vehicle, placing upright bars against outboard vertical surface of frame. Align hole in the upright bar with the existing slot in the frame - both sides.		
3	Loosely install fasteners through the slot in the frame and upright bar as shown.		
4	1994 and Prior Models: Using the hole in the hitch bracket as a template, drill M12 hole through the frame rail. Install hitch-frame fasteners as shown.		
5	1995 & Later Models: Install hitch-frame fasteners as shown. Torque all M14 fasteners to 126 lb.-ft. and all M12 fasteners to 86 lb.-ft.		
***Periodically Check The Receiver Hitch To Ensure That All Fasteners *** Are Tight & All Structural Components Are Sound.			

The instruction here is for your reference only. We strongly recommend the professional installer for best result.
We are not responsible for any damage caused by the installation. Thank you for choosing our product!