



Hitch Installation Instruction

REV.20240601

Part#	HT-X30193	Application	For 2015-2024 Ford Transit-150/Transit-250/Transit-350 ALL/2022-2024 Ford E-Transit ALL
-------	-----------	-------------	---

Hardware List	Item	Part Name	QTY	Description	Item	Part Name	QTY	Description
Hitch Parts	A	Hitch Body	1		B/C	Mounting Brackets	2	B-Driver Side C-Passenger Side
	HW B (For Hitch Installation)	1	Hex Bolts	4	M12X1.75-30	4	Hex Flange Nuts	2
2		Carriage Bolts	2	M12X1.75-40	5	Fishwires	2	
3		Spacers	2	With SQ Hole				
HW A (For Hitch Assembly)	6	Hex Bolts	8	M12X1.75-35	8	Hex Flange Nuts	8	M12
	7	Flat Washers	16	M12				

Gross Load Capacity When Used As A Weight Carrying Hitch: 6000 LBS. Trailer Weight & 900 LBS. Tongue Weight.
 Gross Load Capacity When Used As A Weight Distribution Hitch: 8000 LBS. Trailer Weight & 900 LBS. Tongue Weight.
*****DO NOT EXCEED VEHICLE MANUFACTURER'S RECOMMENDED TOWING CAPACITY.*****

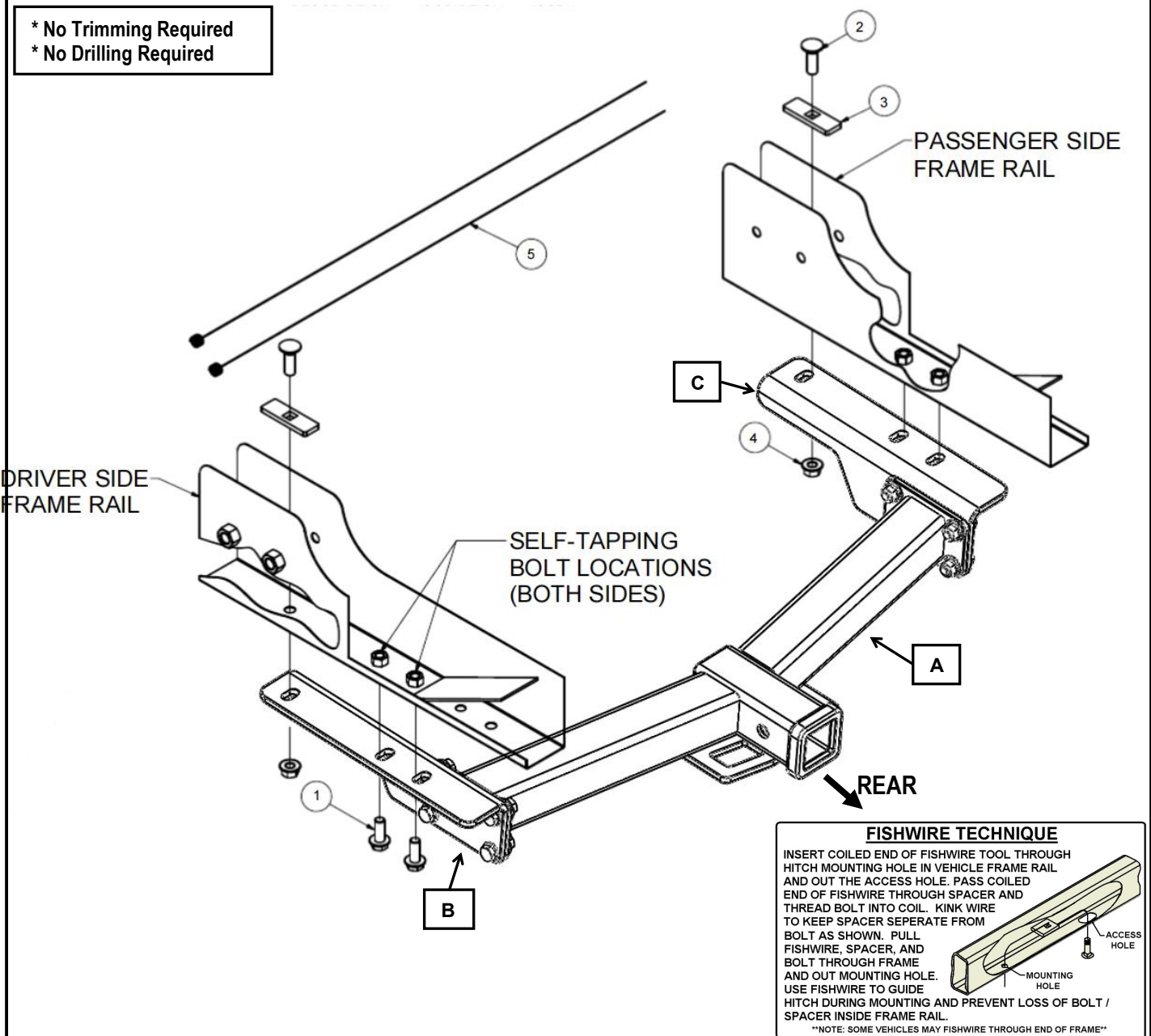

The instruction here is for your reference only. We strongly recommend the professional installer for best result. We are not responsible for any damage caused by the installation. Thank you for choosing our product!



Hitch Installation Instruction

Part#	HT-X30193	Application	For 2015-2024 Ford Transit-150/Transit-250/Transit-350 ALL 2022-2024 Ford E-Transit ALL
-------	-----------	-------------	---

Step	Description
1	Assemble Hitch Body (A) and Mounting Brackets (B, C) with (8) M12X1.75-35mm Hex Bolts, (16) M12 Flat Washers, (8) M12 Hex Flange Nuts.(Hardware in "HW A").
2	Clean frame bolt locations as needed with lubricant and brush. Thread self-tapping bolts into locations as shown (4 places). Thread the bolt half-way or more while keeping the bolt perpendicular to the frame rail, remove the bolts to be installed later. NOTE: Using a M12-1.75 tap may ease installation.



3	Fishwire (1) Carriage bolt and spacer into each frame rail.
---	---



4	Raise hitch into location, careful not to push bolts back into frame and secure with the provided M12 hex bolts along with the M12X1.75 hex nuts. Torque M12 carriage bolts to 58 ft-lbs. Torque M12 hex bolts to 86 ft-lbs.
---	---



5	Installation Complete.
---	------------------------

*****Periodically Check The Receiver Hitch To Ensure That All Fasteners ***
Are Tight & All Structural Components Are Sound.**

The instruction here is for your reference only. We strongly recommend the professional installer for best result. We are not responsible for any damage caused by the installation. Thank you for choosing our product!