



## Hitch Installation Instruction

REV.20251001

Part#	HT-X36825	Application	For 1995-2004 Chevrolet Blazer All\1995-2001 GMC Jimmy All\1996-2004 Oldsmobile Bravada All					
-------	-----------	-------------	---	--	--	--	--	--

Hardware List	Item	Part Name	QTY	Description	Item	Part Name	QTY	Description
Hitch Parts	A	Hitch Body	1		B/C	Mounting Brackets	2	B-Driver Side C-Passenger Side
	1#	Carriage Bolts	6	M12X1.75-45	3#	Spacers	6	With Square Hole
HW B (For Hitch Installation)	2#	Hex Flange Nuts	6	M12X1.75				
	4#	Hex Bolts	8	M12X1.75-35	6#	Hex Flange Nuts	8	M12
HW A (For Hitch Assembly)	5#	Flat Washers	16	M12				

Gross Load Capacity When Used As A Weight Carrying Hitch: 5000 LBS. Trailer Weight & 500 LBS. Tongue Weight.  
Gross Load Capacity When Used As A Weight Distribution Hitch: 6000 LBS. Trailer Weight & 600 LBS. Tongue Weight.

\*\*\*DO NOT EXCEED VEHICLE MANUFACTURER'S RECOMMENDED TOWING CAPACITY.\*\*\*

- \* No Trimming Required
- \* No Drilling Required

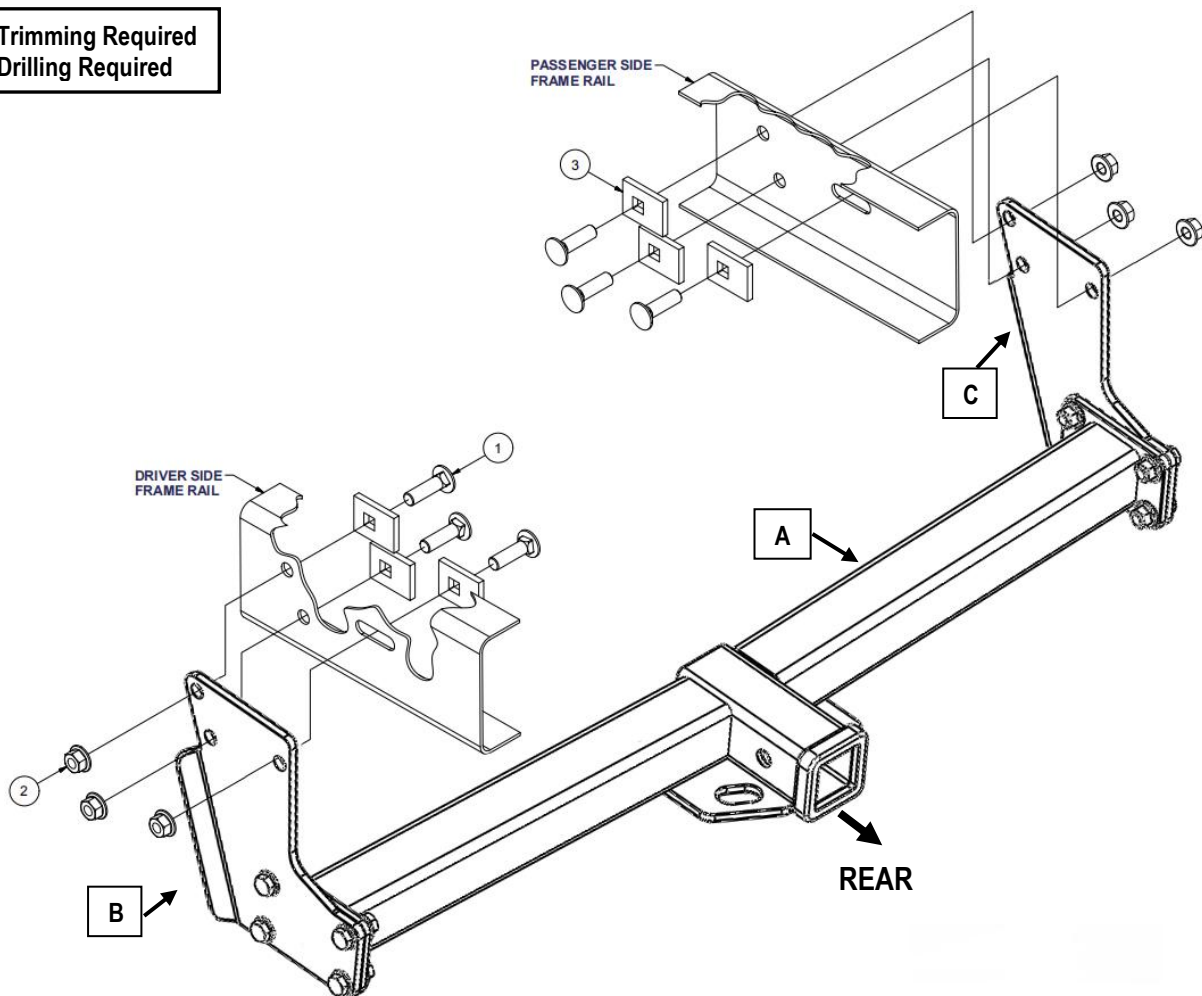

Step	Description
1	Assemble Hitch Body (A) and Mounting Brackets (B, C) with (8) M12X1.75-35mm Hex Bolts, (16) M12 Flat Washers, (8) M12 Hex Flange Nuts.(Hardware in "HW A"). <b>Note:Finger tighten only. Do not fully tighten at this time.</b>
2	Raise hitch into position and install fasteners as shown.
3	Torque M12 Carriage bolts to 58 lb-ft. Torque other M12 fasteners to 86 lb-ft.

\*\*\*Periodically Check The Receiver Hitch To Ensure That All Fasteners \*\*\*  
Are Tight & All Structural Components Are Sound.

The instruction here is for your reference only. We strongly recommend the professional installer for best result.  
We are not responsible for any damage caused by the installation. Thank you for choosing our product!