



# Hitch Installation Instruction

REV.20240401

Part#	HT-R38920	Application	For 2005-2010 Chrysler 300 ALL\2005-2008 Dodge Magnum ALL\2006-2010 Dodge Challenger ALL
-------	-----------	-------------	------------------------------------------------------------------------------------------

Hardware List	Item	Part Name	QTY	Description	Item	Part Name	QTY	Description
	1	Fishwire	1		4	Hex Flange Nuts	3	M12X1.75
	2	Hex Bolts	3	M12X1.75-40	5	Spacers	3	With SQ Hole
	3	Conical Washers	3	M12	6	Carriage Bolts	3	M12X1.75-45

Gross Load Capacity When Used As A Weight Carrying Hitch: 3500 LBS. Trailer Weight & 350 LBS. Tongue Weight.  
**\*\*\*DO NOT EXCEED VEHICLE MANUFACTURER'S RECOMMENDED TOWING CAPACITY.\*\*\***

- \* No Trimming Required
- \* No Drilling Required

### FISHWIRE TECHNIQUE

INSERT COILED END OF FISHWIRE TOOL THROUGH HITCH MOUNTING HOLE IN VEHICLE FRAME RAIL AND OUT THE ACCESS HOLE. PASS COILED END OF FISHWIRE THROUGH SPACER AND THREAD BOLT INTO COIL. KINK WIRE TO KEEP SPACER SEPARATE FROM BOLT AS SHOWN. PULL FISHWIRE, SPACER, AND BOLT THROUGH FRAME AND OUT MOUNTING HOLE. USE FISHWIRE TO GUIDE HITCH DURING MOUNTING AND PREVENT LOSS OF BOLT / SPACER INSIDE FRAME RAIL.

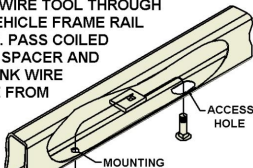

\*\*NOTE: SOME VEHICLES MAY FISHWIRE THROUGH END OF FRAME\*\*

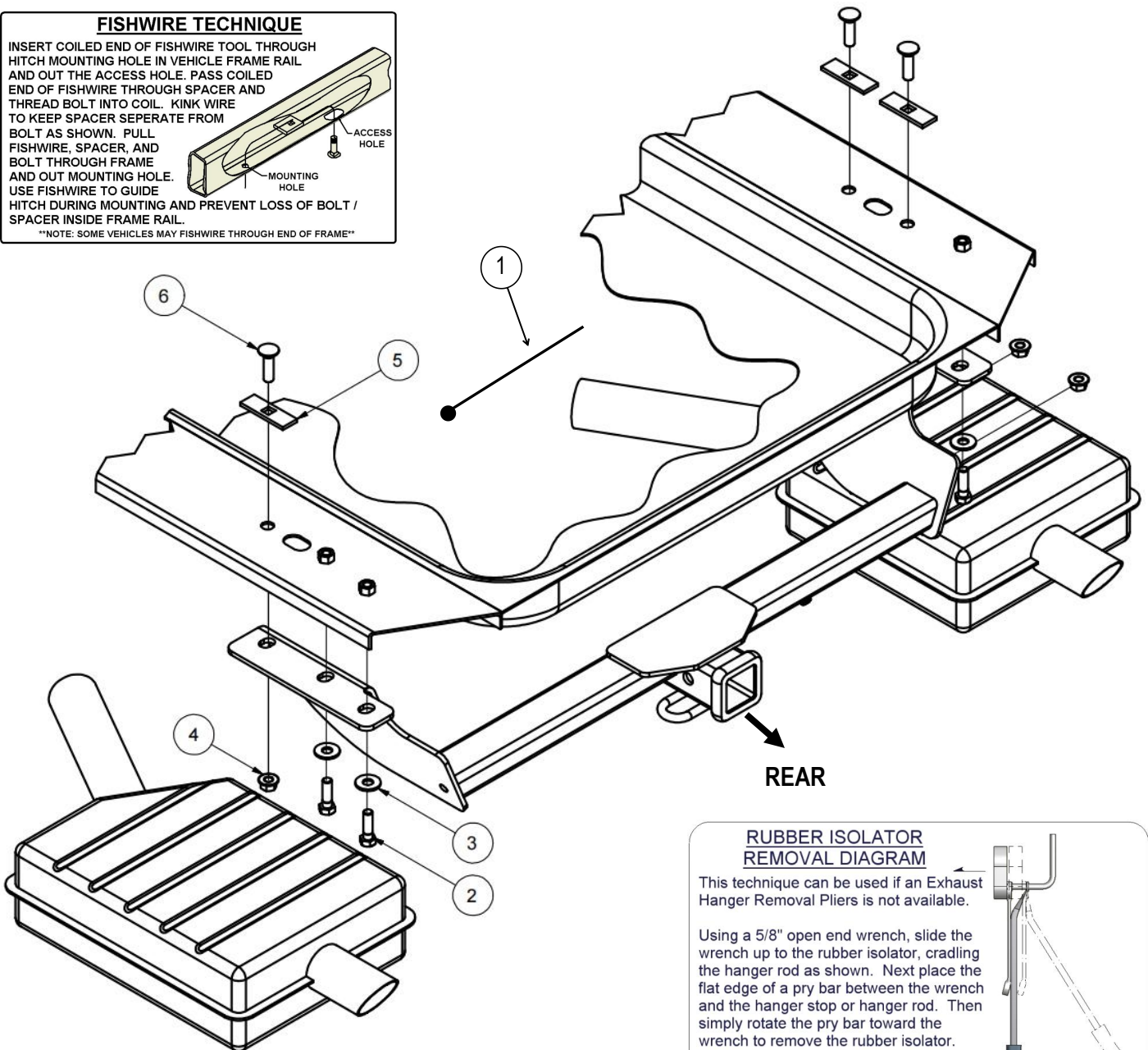

### RUBBER ISOLATOR REMOVAL DIAGRAM

This technique can be used if an Exhaust Hanger Removal Pliers is not available.

Using a 5/8" open end wrench, slide the wrench up to the rubber isolator, cradling the hanger rod as shown. Next place the flat edge of a pry bar between the wrench and the hanger stop or hanger rod. Then simply rotate the pry bar toward the wrench to remove the rubber isolator.

Note: Using a spray lubricant or soapy water on the hanger rod and the rubber isolator helps removal.

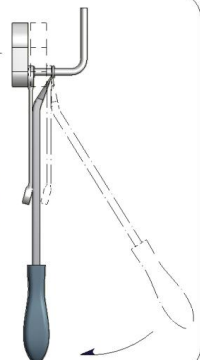

The instruction here is for your reference only. We strongly recommend the professional installer for best result. We are not responsible for any damage caused by the installation. Thank you for choosing our product!



## Hitch Installation Instruction

Part#	HT-R38920	Application	For 2005-2010 Chrysler 300 ALL\2005-2008 Dodge Magnum ALL\2006-2010 Dodge Challenger ALL
-------	-----------	-------------	------------------------------------------------------------------------------------------

Step	Description
1	Lower exhaust by removing the (2) hangers and (1) rubber mount on the 300 limited. (Note the 300C and Dodge Magnum will have (4) hangers and (2) rubber mounts for dual exhaust.)
2	Fishwire M12 carriage bolts and spacer blocks through existing holes in the frame as shown.
3	Slide hitch over muffler(s) and into position over the M12 carriage bolts. Secure with flange nuts, finger tight only.
4	Install 12mm hex bolts and conical washers in remaining holes, finger tight only.
5	Torque M12 Carriage Bolt to 58 lb-ft, torque M12 Hex Bolts to 86 lb-ft.
6	Reinstall exhaust hangers removed in step (1).
<b>***Periodically Check The Receiver Hitch To Ensure That All Fasteners *** Are Tight &amp; All Structural Components Are Sound.</b>	

The instruction here is for your reference only. We strongly recommend the professional installer for best result. We are not responsible for any damage caused by the installation. Thank you for choosing our product!